

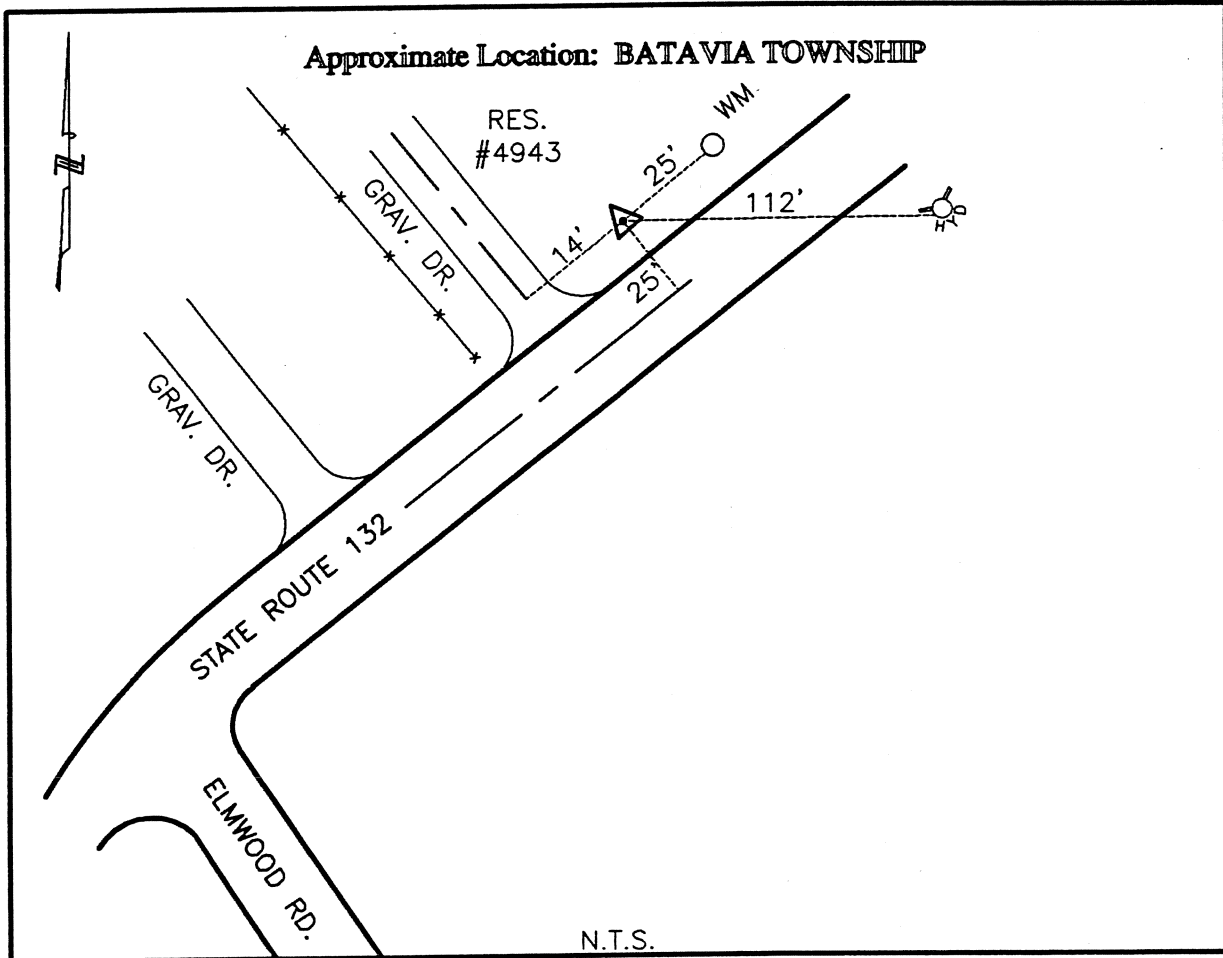

CLERMONT COUNTY ENGINEER
CONTROL STATION DATA SHEET



Station Name: 120

NAD 1983 (First Order)

State Plane Zone: Ohio South 3402
 Latitude (dms) N 39 06 25.65341
 Longitude (dms) W 84 08 40.99736
 Easting in meters 457754.111
 Northing in meters 124201.033
 Easting in US survey ft 1501814.946
 Northing in US survey ft 407482.889
 Scale .99994750
 Convergence (dms) -1 2 36.988502

NAVD 1988

Elevation in meters 264.729
 Elevation in feet 868.532
 Geoid Ht. in meters -34.049
 Elevations determined with GPS

Azimuth: N 65° 00' 43" E to Station 120A.