

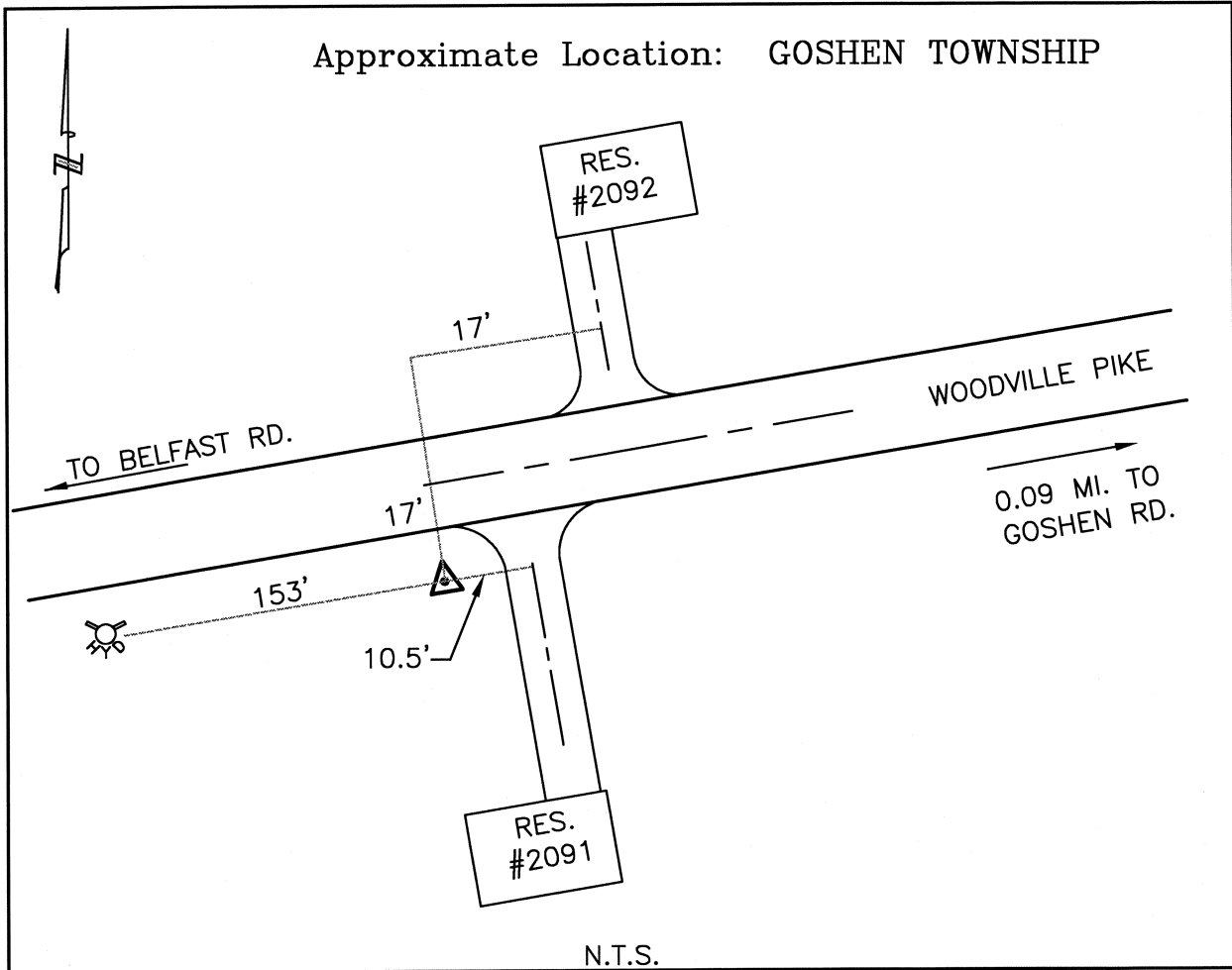

# CLERMONT COUNTY ENGINEER CONTROL STATION DATA SHEET



Station Name: 122

NAD 1983 (First Order)  
 State Plane Zone: Ohio South 3402  
 Latitude (dms) N 39 12 44.55762  
 Longitude (dms) W 84 08 47.65857  
 Easting in meters 457807.148  
 Northing in meters 135886.179  
 Easting in US survey ft 1501988.951  
 Northing in US survey ft 445819.906  
 Scale .99994040  
 Convergence (dms) -1 2 41.215170

NAVD 1988  
 Elevation in meters 262.392  
 Elevation in feet 860.864  
 Geoid Ht. in meters -33.950  
 Elevations determined with GPS

Azimuth: S 77° 46' 39" W to Station 122A.