

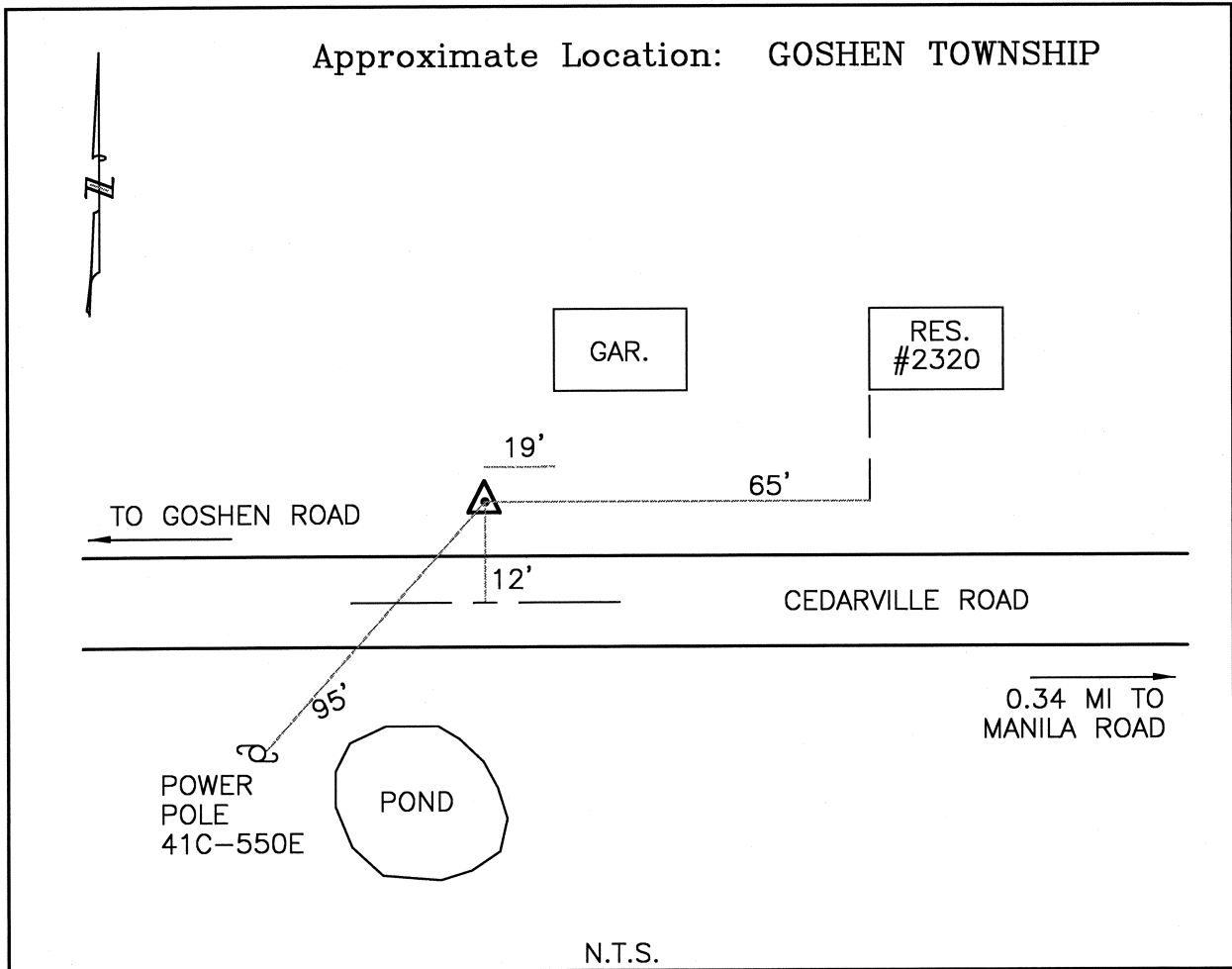

CLERMONT COUNTY ENGINEER CONTROL STATION DATA SHEET

Approximate Location: GOSHEN TOWNSHIP



Station Name: 129

NAD 1983 (First Order)

State Plane Zone: Ohio South 3402
 Latitude (dms) N 39 11 56.60960
 Longitude (dms) W 84 07 45.20728
 Easting in meters 459278.392
 Northing in meters 134380.678
 Easting in US survey ft 1506815.858
 Northing in US survey ft 440880.608
 Scale .99994110
 Convergence (dms) -1 2 1.588606

NAVD 1988

Elevation in meters 264.557
 Elevation in feet 867.967
 Geoid Ht. in meters -33.940
 Elevations determined with GPS

Azimuth: S 82° 59' 46" E to Station 129A.