

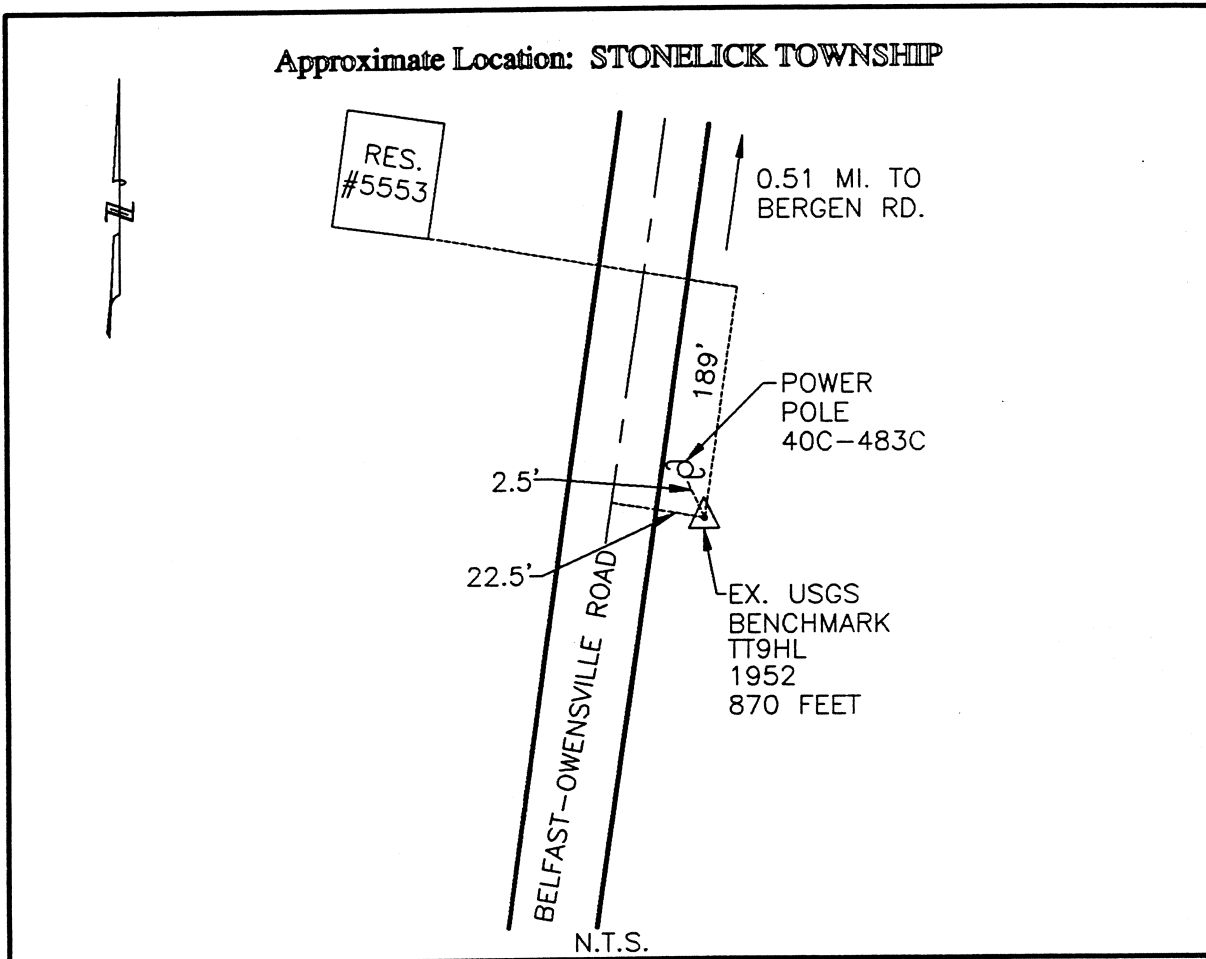

# CLERMONT COUNTY ENGINEER

## CONTROL STATION DATA SHEET

Approximate Location: STONELICK TOWNSHIP



Station Name: 130

NAD 1983 (First Order)

State Plane Zone: Ohio South 3402  
 Latitude (dms) N 39 09 16.91952  
 Longitude (dms) W 84 07 38.11009  
 Easting in meters 459359.917  
 Northing in meters 129454.077  
 Easting in US survey ft 1507083.328  
 Northing in US survey ft 424717.251  
 Scale .99994390  
 Convergence (dms) -1 1 57.085301

NAVD 1988

Elevation in meters 265.193  
 Elevation in feet 870.054  
 Geoid Ht. in meters -33.985  
 Elevations determined with GPS

Azimuth: S 26° 39' 13" W to Station 130A.