

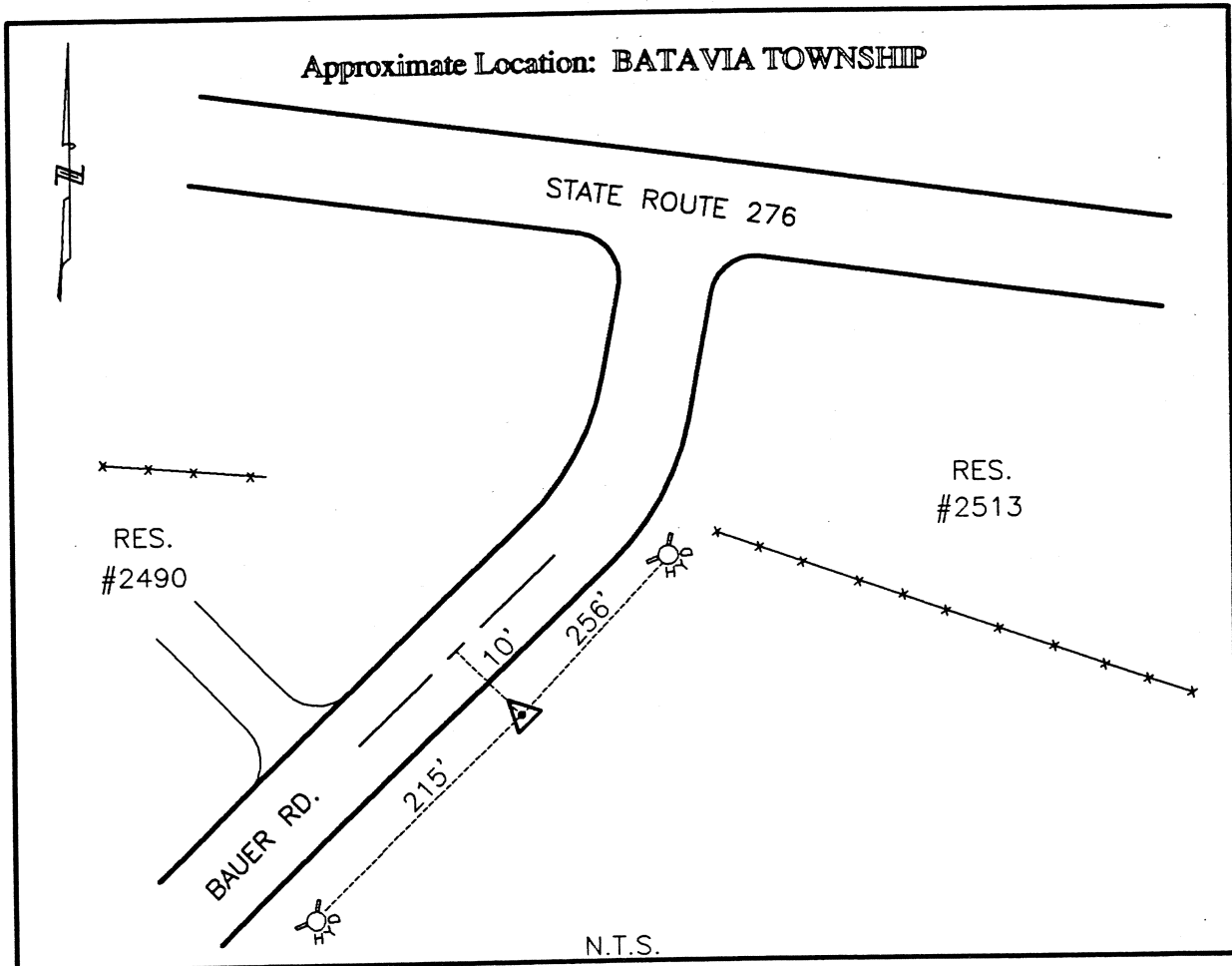

CLERMONT COUNTY ENGINEER  
CONTROL STATION DATA SHEET



Station Name: 133

NAD 1983 (First Order)

State Plane Zone: Ohio South 3402  
 Latitude (dms) N 39 05 49.27730  
 Longitude (dms) W 84 07 34.60351  
 Easting in meters 459328.781  
 Northing in meters 123050.611  
 Easting in US survey ft 1506981.176  
 Northing in US survey ft 403708.546  
 Scale .99994840  
 Convergence (dms) -1 1 54.860307

NAVD 1988

Elevation in meters 269.261  
 Elevation in feet 883.400  
 Geoid Ht. in meters -34.025  
 Elevations determined with GPS

Azimuth: S 56° 05' 52" W to Station 133A.