

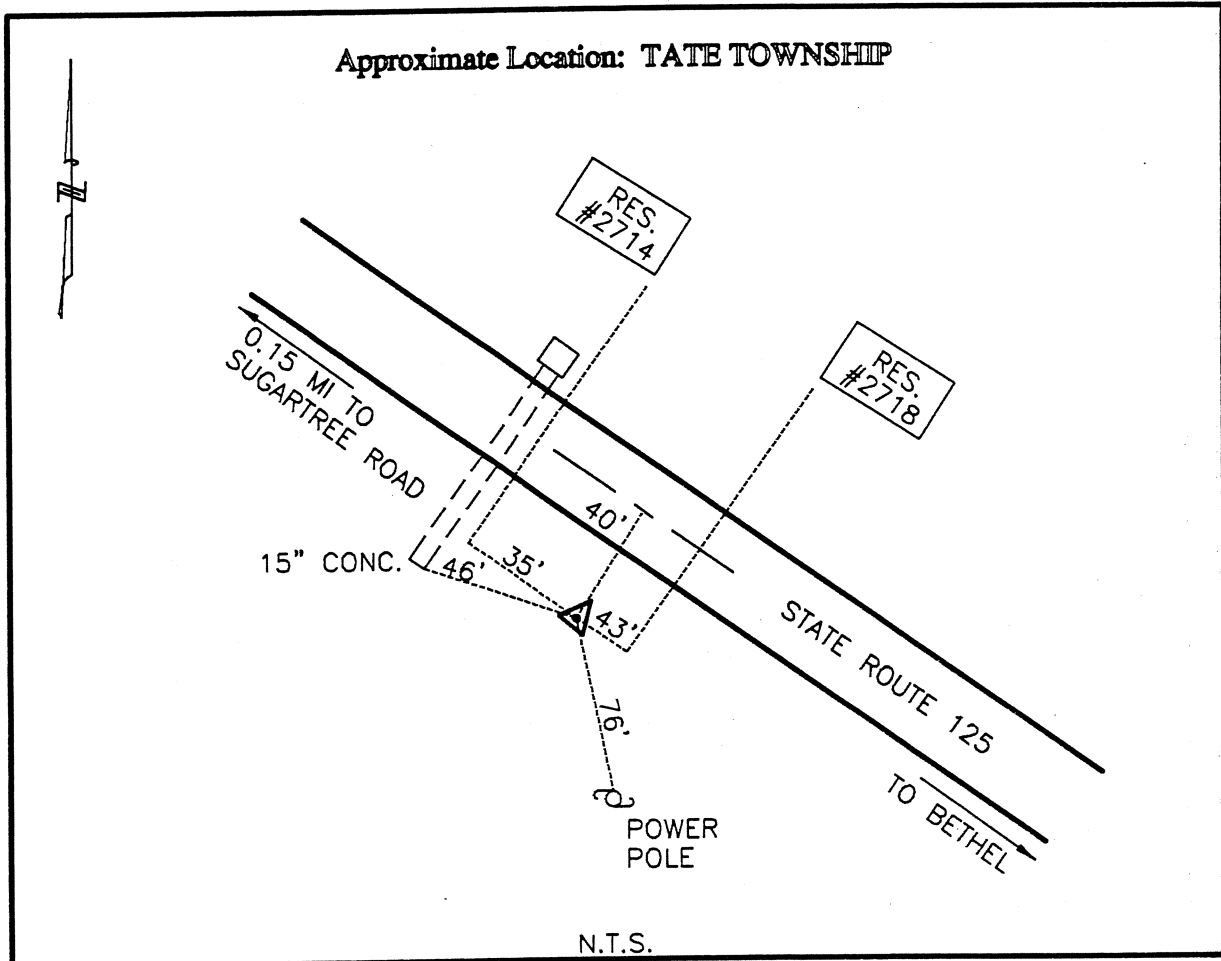

CLERMONT COUNTY ENGINEER

CONTROL STATION DATA SHEET

Approximate Location: TATE TOWNSHIP



Station Name : 137

NAD 1983 (First Order)
 State Plane Zone: Ohio South 3402
 Latitude (dms) N 38 59 10.621 67
 Longitude (dms) W 84 07 24.366 45
 Easting in meters 459 353.7 23
 Northing in meters 110 755.0 54
 Easting in US survey ft 1507 063.0 06
 Northing in US survey ft 363 368.8 73
 Scale .999959 90
 Convergence (dms) -1 1 48.3646 93

NAVD 1988
 Elevation in meters 262.7 34
 Elevation in feet 861.9 86
 Geoid Ht. in meters -34.0 75
 Elevations determined with GPS

Azimuth: N 45° 45' 48" W to Station 137A.