

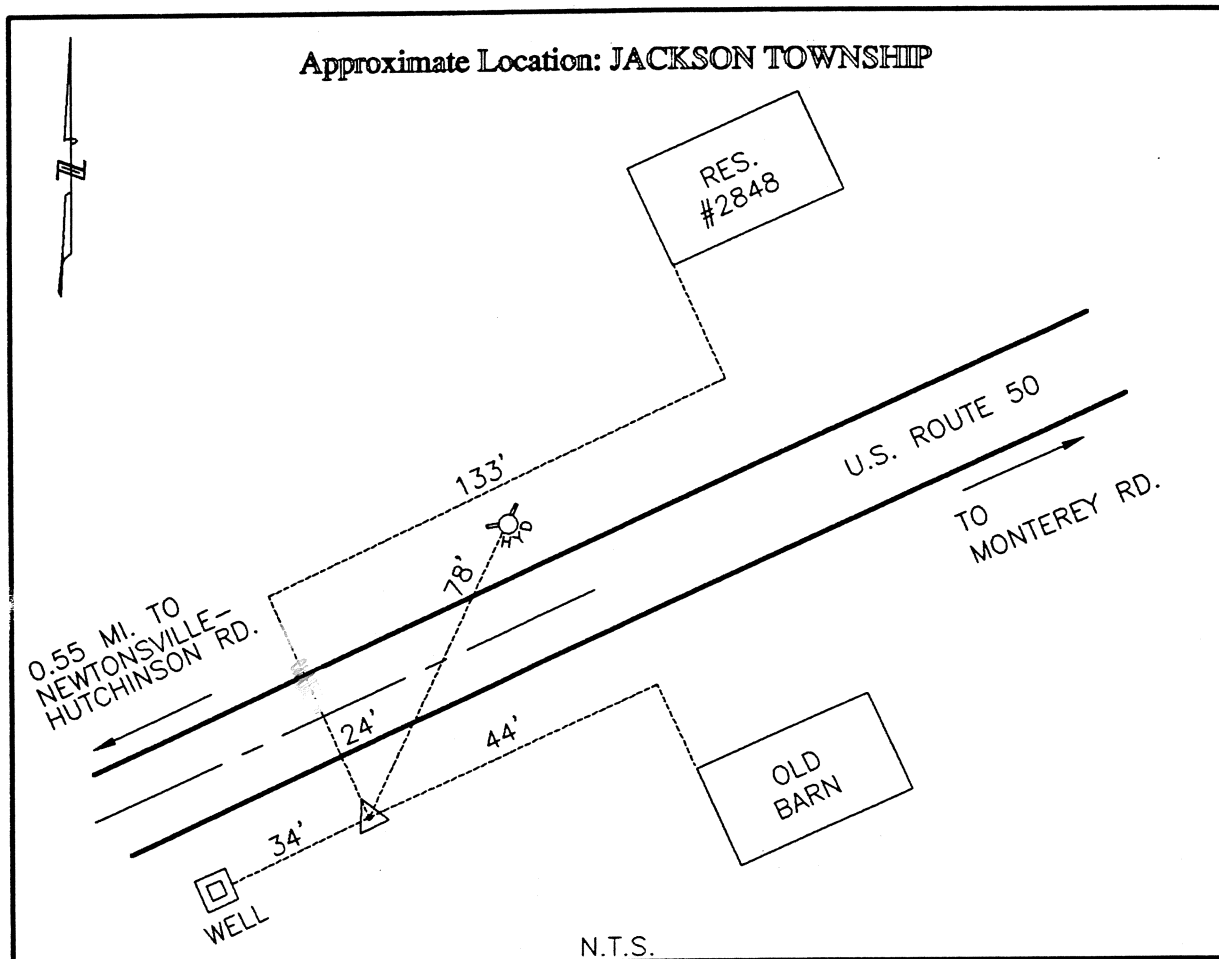

CLERMONT COUNTY ENGINEER

CONTROL STATION DATA SHEET

Approximate Location: JACKSON TOWNSHIP



Station Name: 150

NAD 1983 (First Order)

State Plane Zone: Ohio South 3402
 Latitude (dms) N 39 07 53.22291
 Longitude (dms) W 84 05 30.14211
 Easting in meters 462386.327
 Northing in meters 126818.792
 Easting in US survey ft 1517012.474
 Northing in US survey ft 416071.320
 Scale .99994560
 Convergence (dms) -1 0 35.887117

NAVD 1988

Elevation in meters 272.388
 Elevation in feet 893.660
 Geoid Ht. in meters -33.944
 Elevations determined with GPS

Azimuth: S 77° 36' 39" W to Station 150A.