

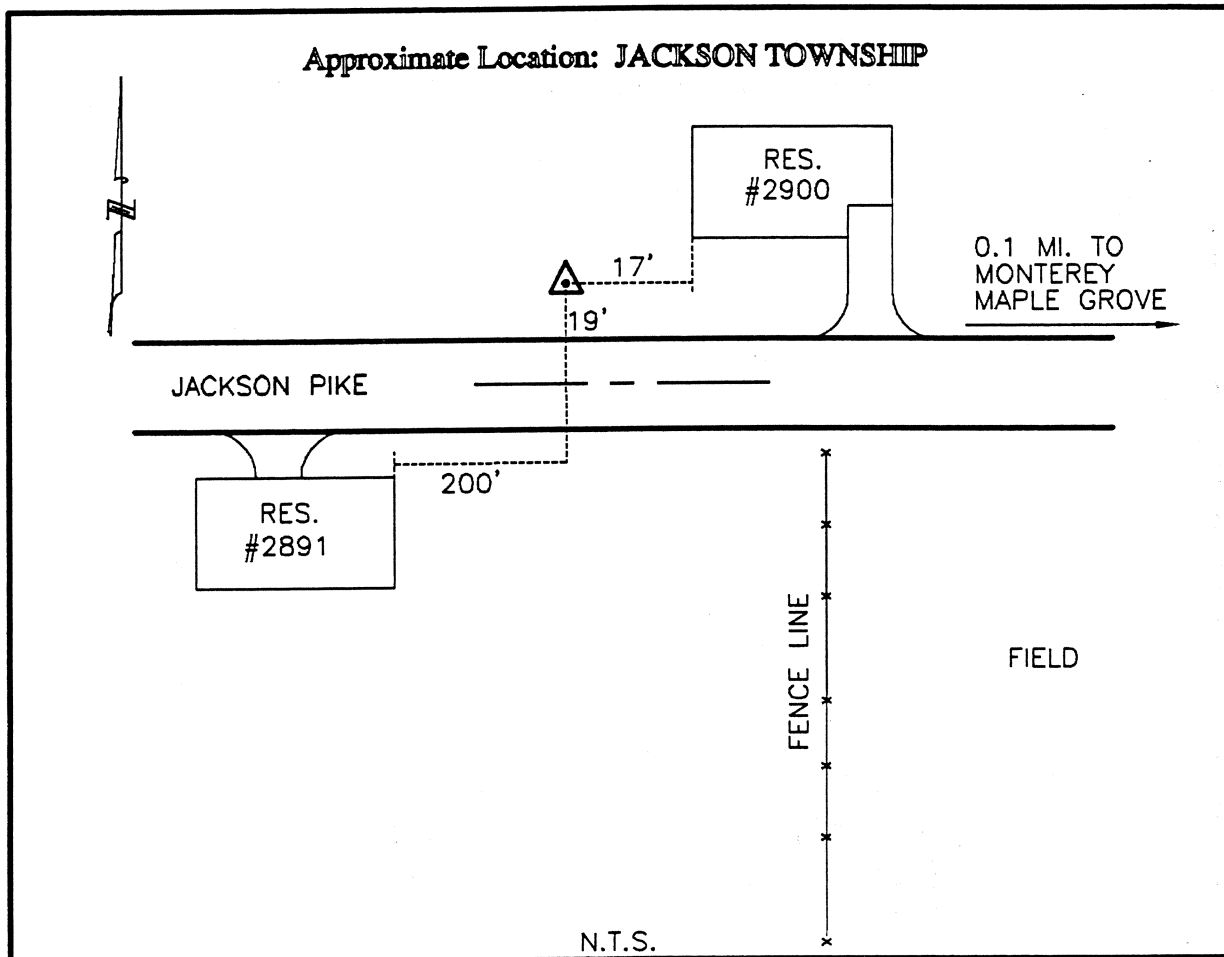

CLERMONT COUNTY ENGINEER

CONTROL STATION DATA SHEET

Approximate Location: JACKSON TOWNSHIP



Station Name : 151

NAD 1983 (First Order)

State Plane Zone: Ohio South 3402
 Latitude (dms) N 39 06 32.082 26
 Longitude (dms) W 84 05 27.444 08
 Easting in meters 462407.034
 Northing in meters 124315.935
 Easting in US survey ft 1517080.411
 Northing in US survey ft 407859.863
 Scale .99994740
 Convergence (dms) -1 0 34.175165

NAVD 1988

Elevation in meters 276.411
 Elevation in feet 906.858
 Geoid Ht. in meters -33.956
 Elevations determined with GPS

Azimuth: S 81° 35' 52" E to Station 151A.