

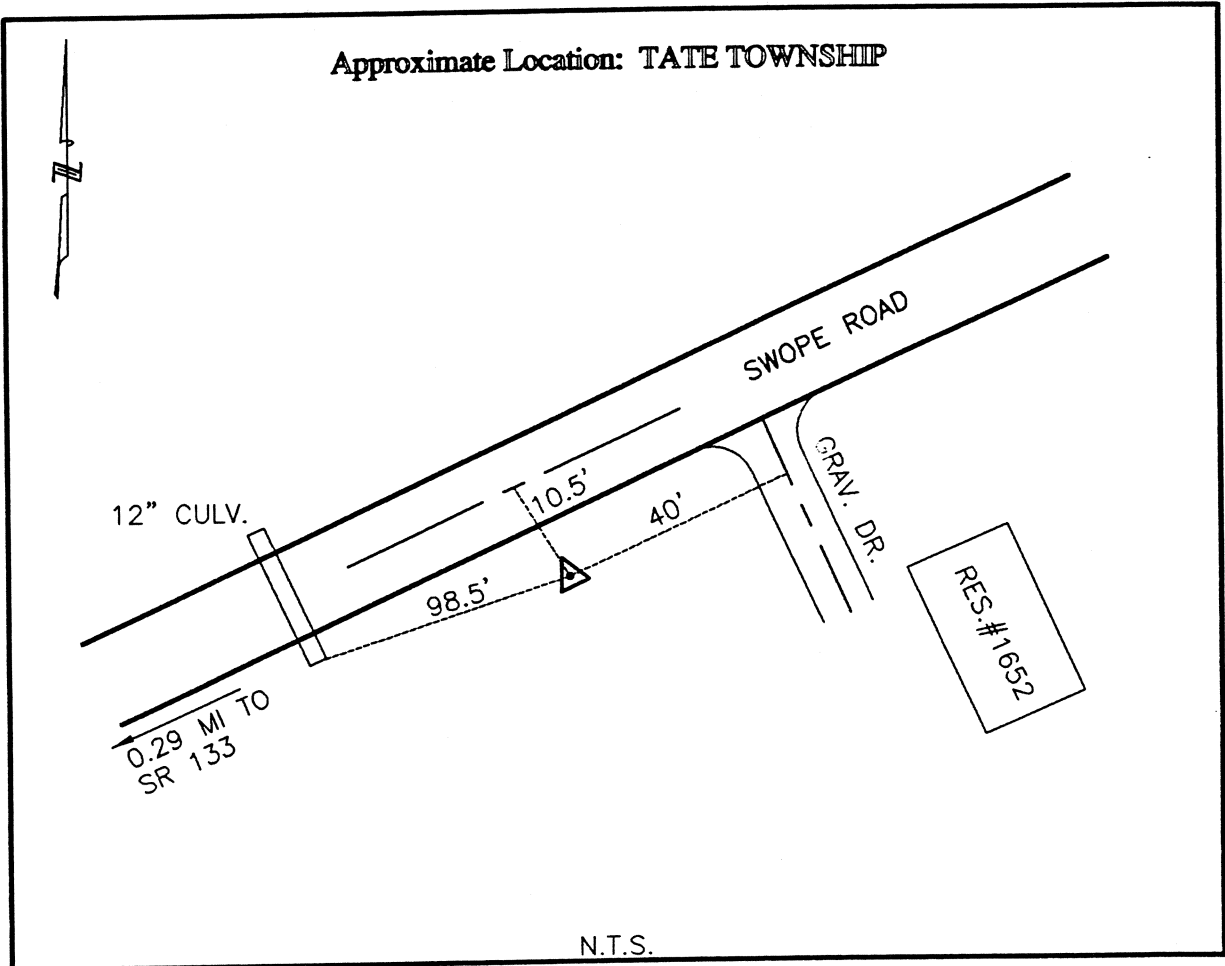

CLERMONT COUNTY ENGINEER  
CONTROL STATION DATA SHEET



Station Name: 158

NAD 1983 (First Order)

State Plane Zone: Ohio South 3402  
 Latitude (dms) N 38 53 22.40842  
 Longitude (dms) W 84 05 14.64055  
 Easting in meters 462286.534  
 Northing in meters 99963.614  
 Easting in US survey ft 1516685.070  
 Northing in US survey ft 327963.957  
 Scale .99997290  
 Convergence (dms) -1 0 26.051075

NAVD 1988

Elevation in meters 269.311  
 Elevation in feet 883.565  
 Geoid Ht. in meters -34.072  
 Elevations determined with GPS

Azimuth: N 53° 15' 37" E to Station 158A.