

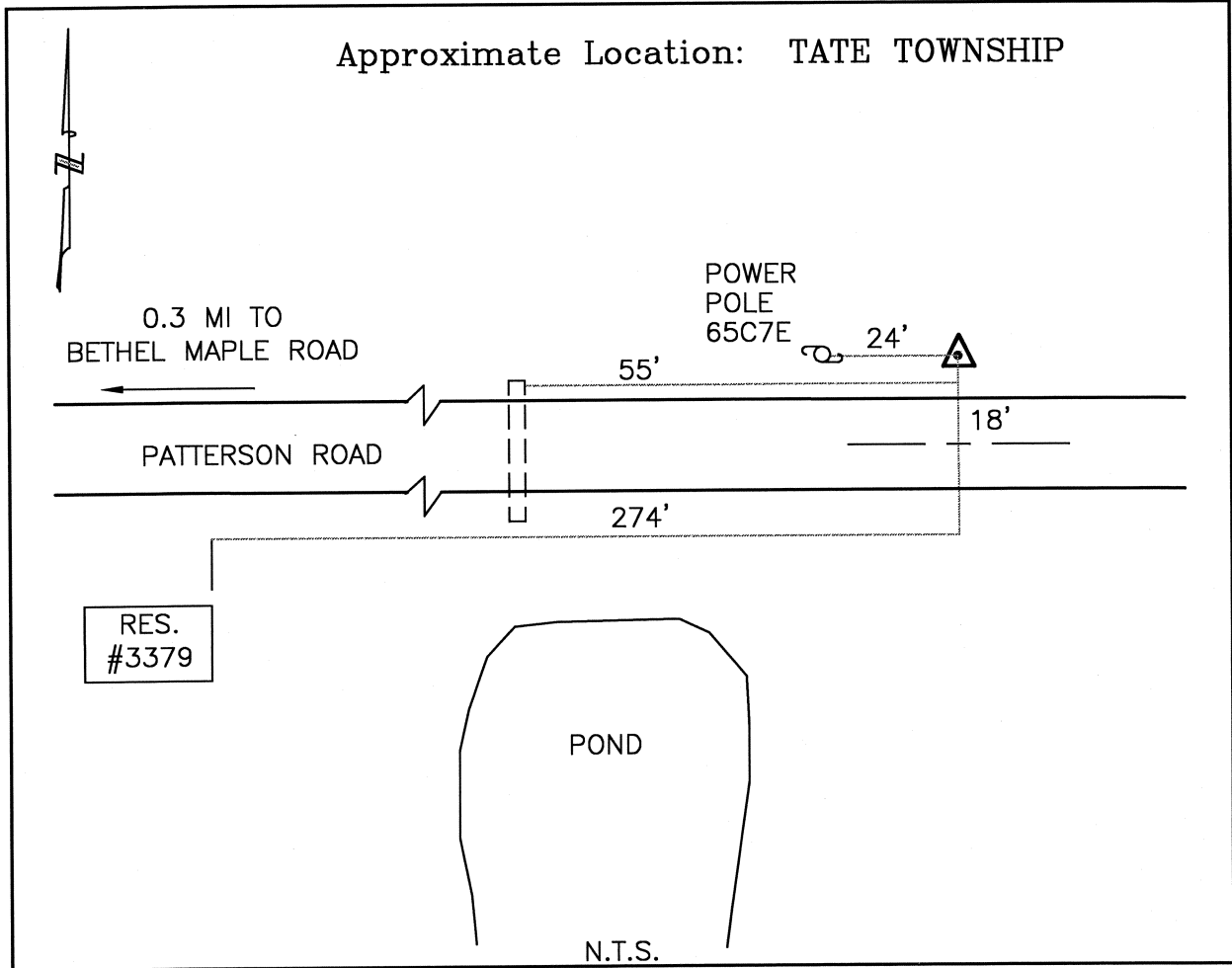

CLERMONT COUNTY ENGINEER

CONTROL STATION DATA SHEET



Station Name: 161

NAD 1983 (First Order)

State Plane Zone: Ohio South 3402

Latitude (dms) N 38 57 9.48959

Longitude (dms) W 84 04 9.77162

Easting in meters 463971.305

Northing in meters 106937.561

Easting in US survey ft 1522212.523

Northing in US survey ft 350844.315

Scale .99996410

Convergence (dms) 0-59 44.890471

NAVD 1988

Elevation in meters 276.112

Elevation in feet 905.877

Geoid Ht. in meters -34.007

Elevations determined with GPS

Azimuth: N 84° 00' 34" W to Station 161A.