

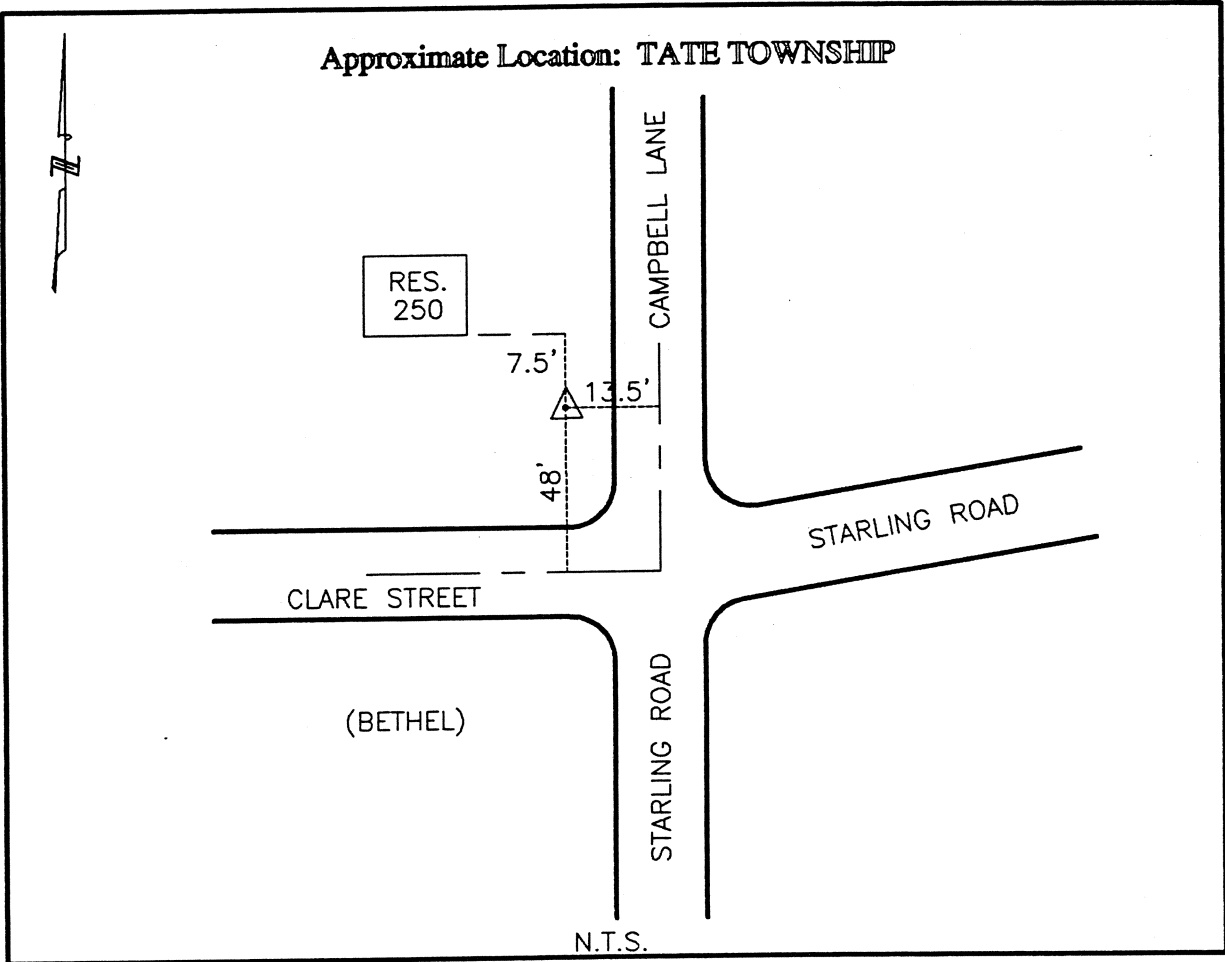

CLERMONT COUNTY ENGINEER

CONTROL STATION DATA SHEET

Approximate Location: TATE TOWNSHIP



Station Name: 162

NAD 1983 (First Order)

State Plane Zone: Ohio South 3402
 Latitude (dms) N 38 57 53.10600
 Longitude (dms) W 84 04 11.40806
 Easting in meters 463955.290
 Northing in meters 108283.011
 Easting in US survey ft 1522159.981
 Northing in US survey ft 355258.512
 Scale .99996260
 Convergence (dms) 0-59 45.928824

NAVD 1988

Elevation in meters 275.334
 Elevation in feet 903.325
 Geoid Ht. in meters -34.000
 Elevations determined with GPS

Azimuth: N 07° 47' 33" E to Station 162A.