

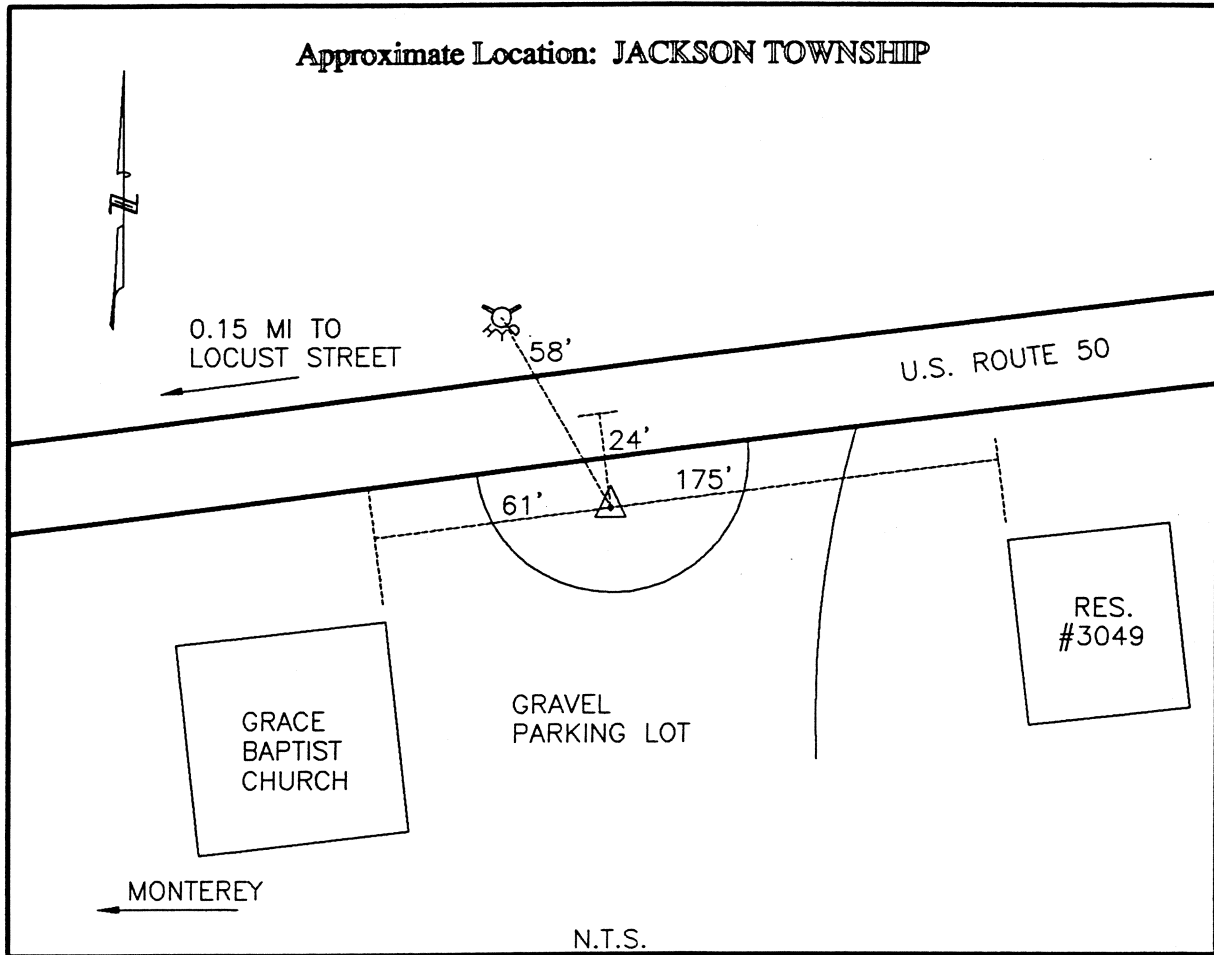

CLERMONT COUNTY ENGINEER
CONTROL STATION DATA SHEET

Approximate Location: JACKSON TOWNSHIP



Station Name: 169

NAD 1983 (First Order)

State Plane Zone: Ohio South 3402
 Latitude (dms) N 39 08 5.35450
 Longitude (dms) W 84 04 27.76009
 Easting in meters 463890.848
 Northing in meters 127166.568
 Easting in US survey ft 1521948.557
 Northing in US survey ft 417212.315
 Scale .99994530
 Convergence (dms) 0-59 56.304507

NAVD 1988

Elevation in meters 276.800
 Elevation in feet 908.135
 Geoid Ht. in meters -33.911
 Elevations determined with GPS

Azimuth: S 79° 34' 08" W to Station 169A.