

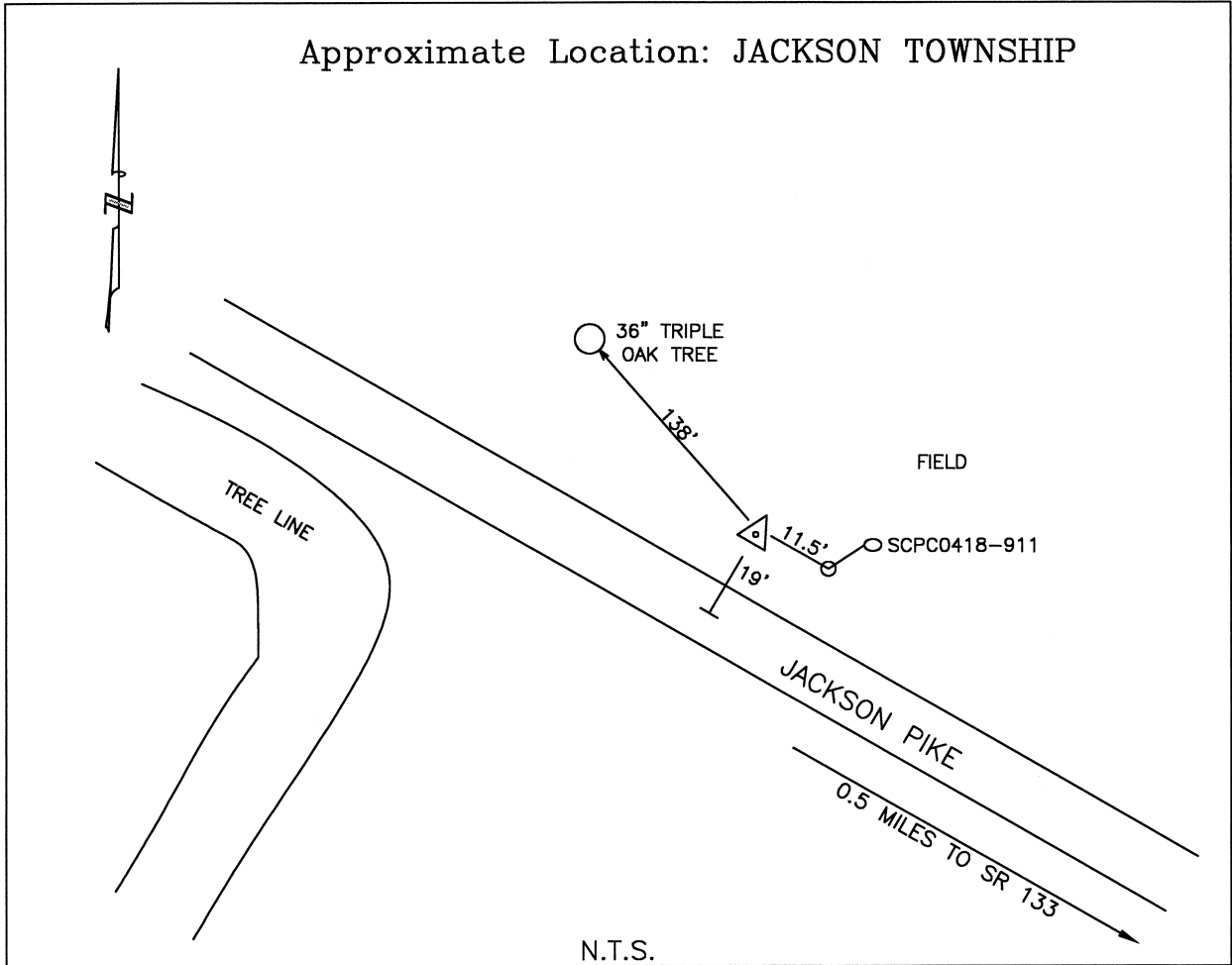

# CLERMONT COUNTY ENGINEER CONTROL STATION DATA SHEET

Approximate Location: JACKSON TOWNSHIP



Station Name: 174RESET

NAD 1983  
 State Plane Zone: Ohio South 3402  
 Latitude (dms) N 39 06 0.51074  
 Longitude (dms) W 84 03 16.90478  
 Easting in meters 465525.963  
 Northing in meters 123287.898  
 Easting in US survey ft 1527313.097  
 Northing in US survey ft 404487.045  
 Scale 0.99994814  
 Convergence -0 59 11.345430

NAVD 1988  
 Elevation in meters 276.039  
 Elevation in feet 905.637  
 Geoid96 Ht in meters -33.678  
 Elevations determined with GPS

Azimuth: S.69°03'37"E. to Station 174ARESET