

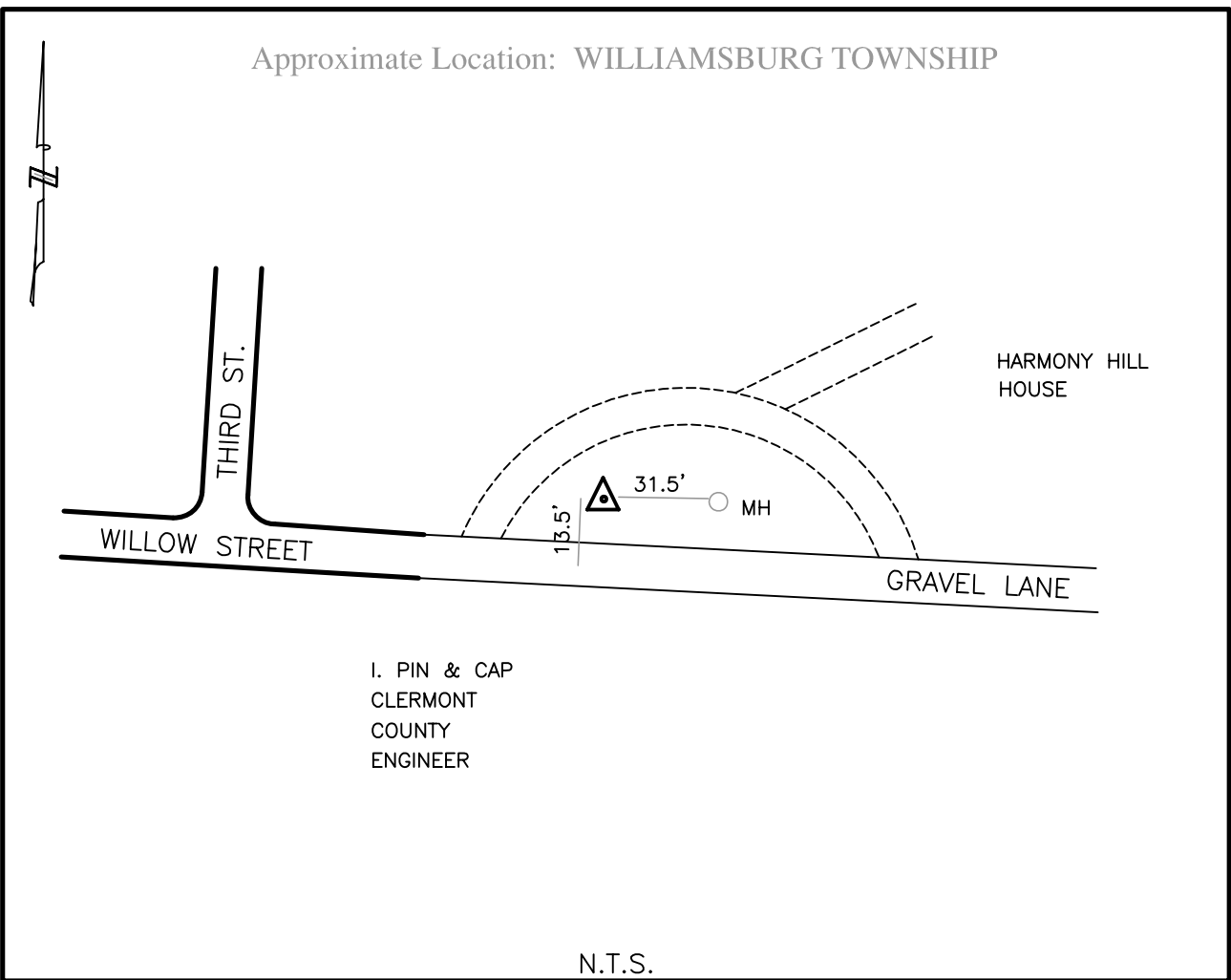

CLERMONT COUNTY ENGINEER

CONTROL STATION DATA SHEET

Approximate Location: WILLIAMSBURG TOWNSHIP



I. PIN & CAP
CLERMONT
COUNTY
ENGINEER

N.T.S.

Station Name: 178

NAD 1983 (First Order)

State Plane Zone: Ohio South 3402
 Latitude (dms) N 39 03 3.07624
 Longitude (dms) W 84 03 18.66715
 Easting in meters 465389.394
 Northing in meters 117817.979
 Easting in US survey ft 1526865.037
 Northing in US survey ft 386541.153
 Scale .99995270
 Convergence (dms) 0-59 12.463687

NAVD 1988

Elevation in meters 268.408
 Elevation in feet 880.602
 Geoid Ht. in meters -33.925
 Elevations determined with GPS

Azimuth: N 54° 10' 43" W to Station 178A.