

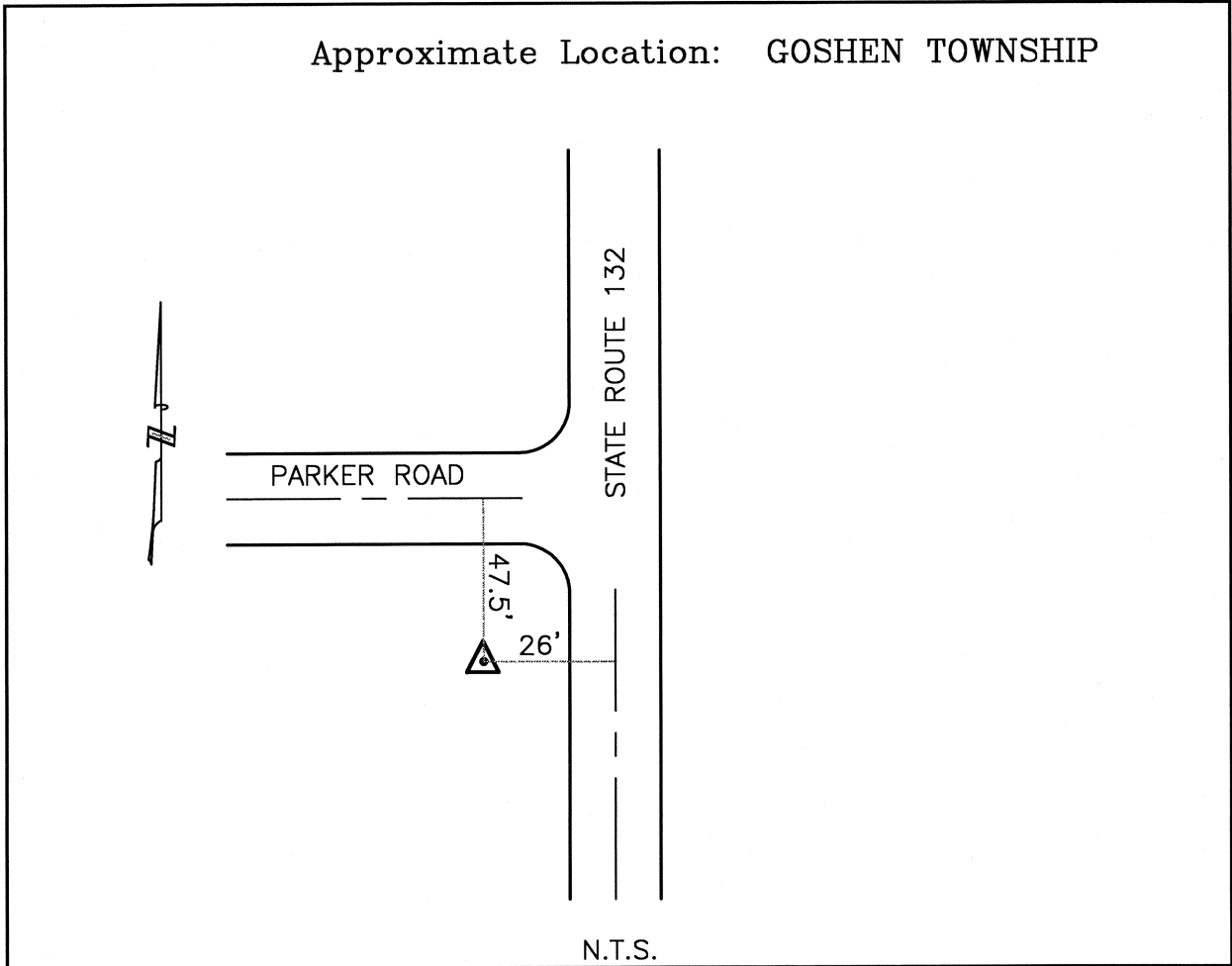

CLERMONT COUNTY ENGINEER  
CONTROL STATION DATA SHEET

Approximate Location: GOSHEN TOWNSHIP



Station Name: 17

NAD 1983 (First Order)

State Plane Zone: Ohio South 3402  
 Latitude (dms) N 39 11 47.91610  
 Longitude (dms) W 84 10 12.67116  
 Easting in meters 455735.790  
 Northing in meters 134177.282  
 Easting in US survey ft 1495193.171  
 Northing in US survey ft 440213.299  
 Scale .99994120  
 Convergence (dms) -1 3 35.157319

NAVD 1988

Elevation in meters 270.064  
 Elevation in feet 886.035  
 Geoid Ht. in meters -34.001  
 Elevations determined with GPS

Azimuth: N 07° 18' 28" W to Station 17A.