

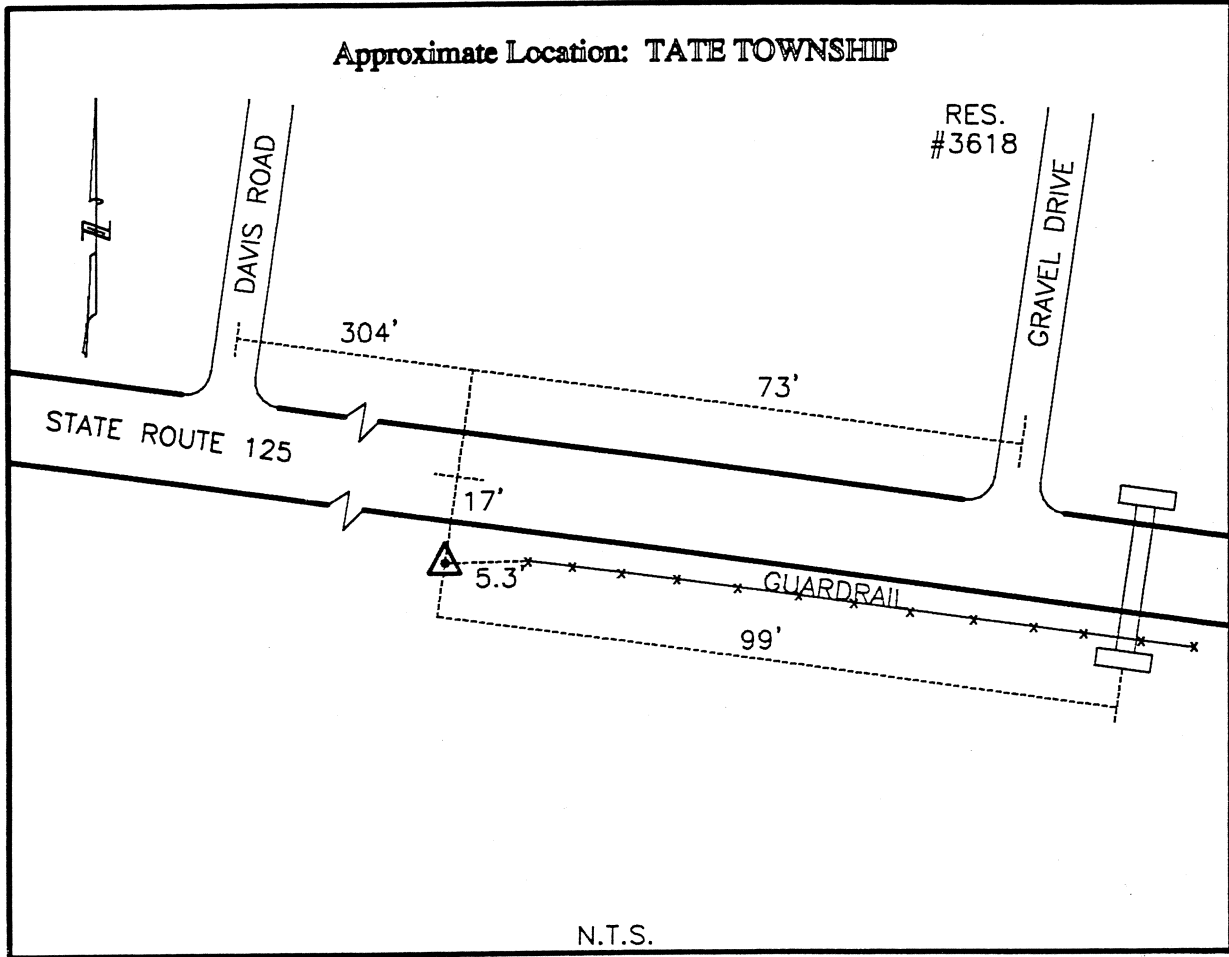

CLERMONT COUNTY ENGINEER
CONTROL STATION DATA SHEET

Approximate Location: TATE TOWNSHIP



N.T.S.

Station Name: 181

NAD 1983 (First Order)

State Plane Zone: Ohio South 3402
 Latitude (dms) N 38 57 31.2788 1
 Longitude (dms) W 84 02 56.8425 4
 Easting in meters 465 738.56 1
 Northing in meters 107 579.04 0
 Easting in US survey ft 1528 010.59 6
 Northing in US survey ft 352 948.90 0
 Scale .9999633 0
 Convergence (dms) 0-58 58.61554 5

NAVD 1988

Elevation in meters 279.094
 Elevation in feet 915.661
 Geoid Ht. in meters -33.971
 Elevations determined with GPS

Azimuth: N 71° 25' 04" W to Station 181A.