

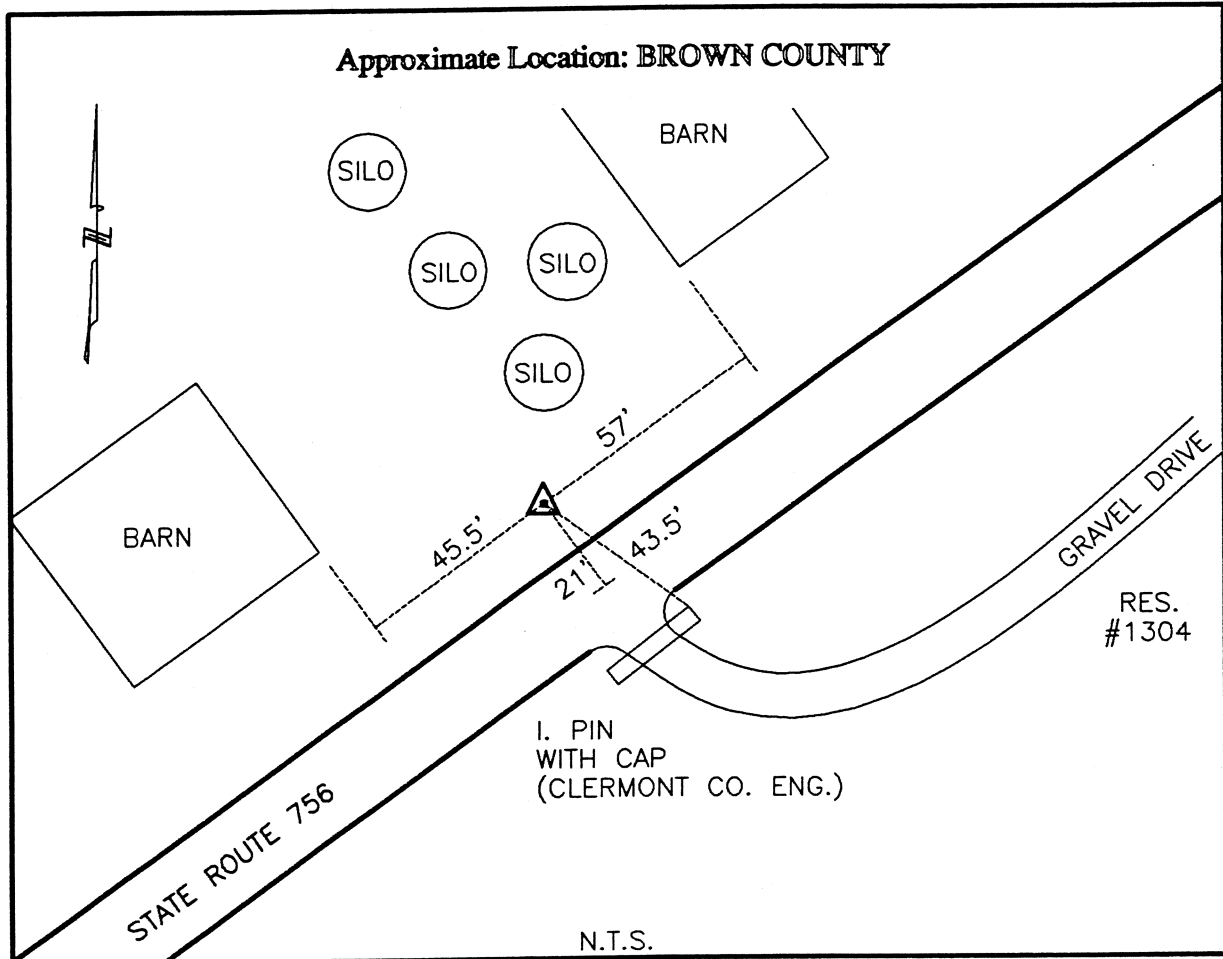

CLERMONT COUNTY ENGINEER  
CONTROL STATION DATA SHEET



Station Name: 196

NAD 1983 (First Order)

State Plane Zone: Ohio South 3402  
 Latitude (dms) N 38 52 2.01083  
 Longitude (dms) W 84 00 50.18564  
 Easting in meters 468617.288  
 Northing in meters 97375.364  
 Easting in US survey ft 1537455.219  
 Northing in US survey ft 319472.340  
 Scale .99997640  
 Convergence (dms) 0-57 38.249268

NAVD 1988

Elevation in meters 275.645  
 Elevation in feet 904.345  
 Geoid Ht. in meters -33.986  
 Elevations determined with GPS

Azimuth: S 54° 29' 05" W to Station 196A.