

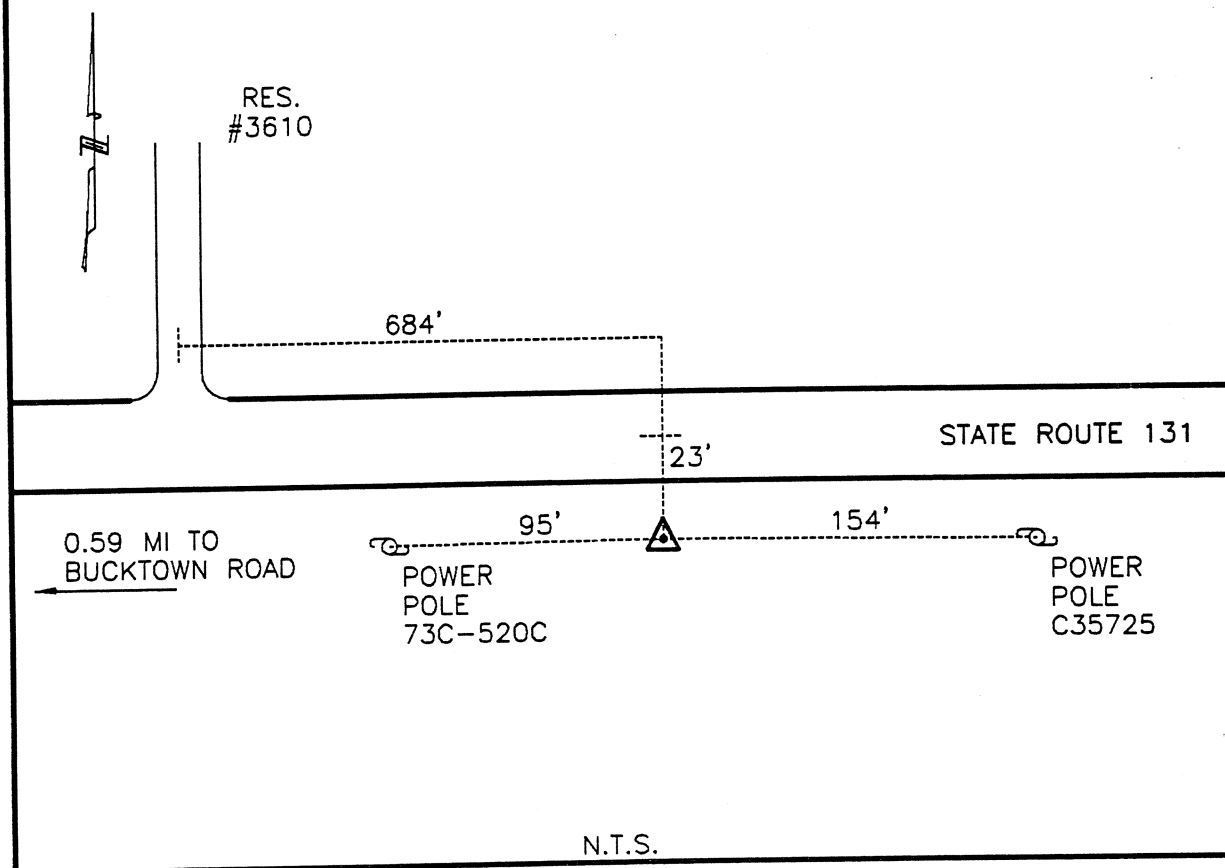

CLERMONT COUNTY ENGINEER
CONTROL STATION DATA SHEET

Approximate Location: JACKSON TOWNSHIP



Station Name: 198

NAD 1983 (First Order)
 State Plane Zone: Ohio South 3402
 Latitude (dms) N 39 10 34.02 578
 Longitude (dms) W 84 01 15.72 889
 Easting in meters 468579.183
 Northing in meters 131671.411
 Easting in US survey ft 1537330.203
 Northing in US survey ft 431991.954
 Scale .99994250
 Convergence (dms) 0-57 54.456959

NAVD 1988
 Elevation in meters 286.744
 Elevation in feet 940.759
 Geoid Ht. in meters -33.771
 Elevations determined with GPS

Azimuth: S 78° 47' 39" E to Station 198A.