

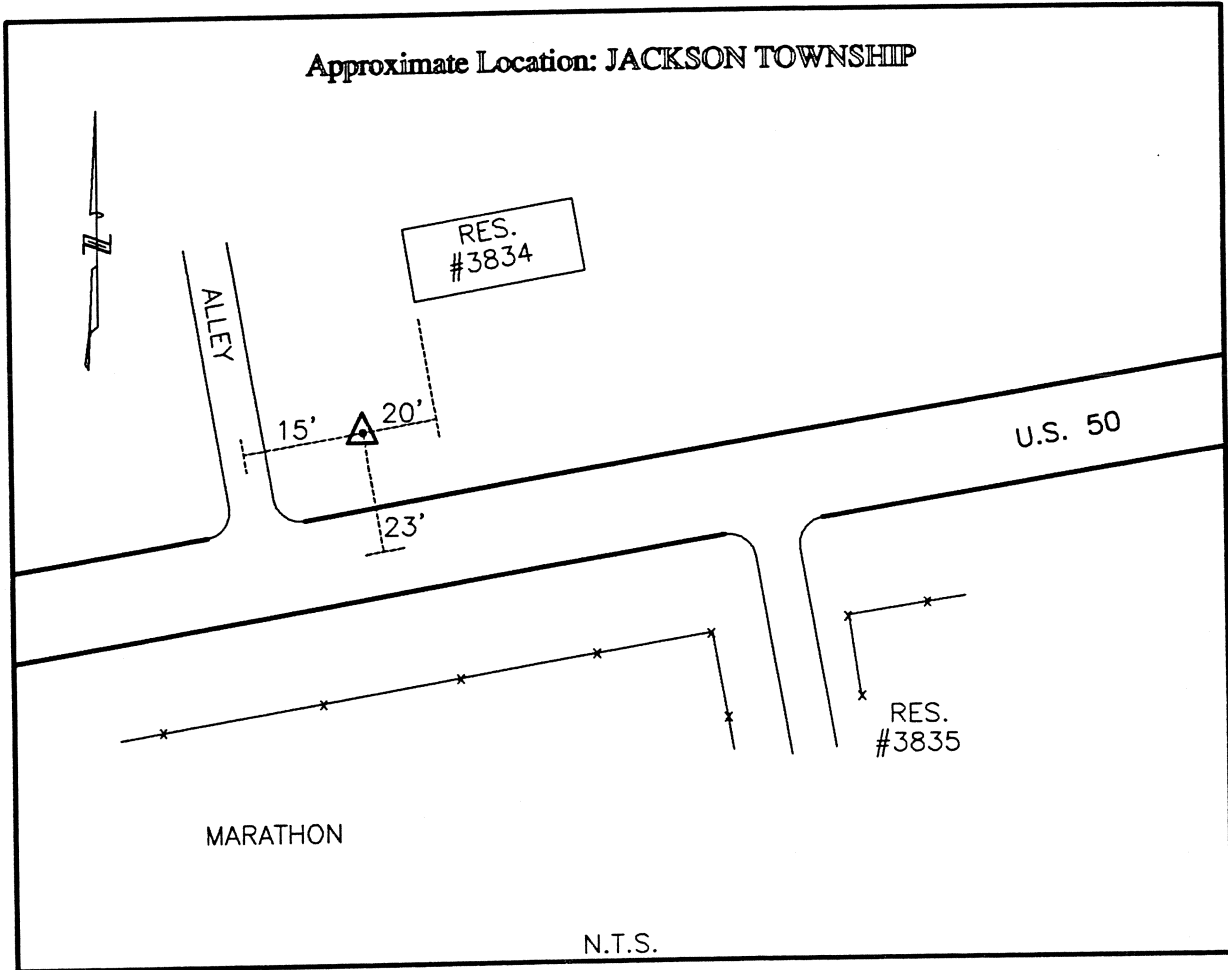

CLERMONT COUNTY ENGINEER
CONTROL STATION DATA SHEET

Approximate Location: JACKSON TOWNSHIP



Station Name: 203

NAD 1983 (First Order)

State Plane Zone: Ohio South 3402
 Latitude (dms) N 39 08 45.67216
 Longitude (dms) W 84 00 14.07373
 Easting in meters 470003.161
 Northing in meters 128305.816
 Easting in US survey ft 1542002.037
 Northing in US survey ft 420949.998
 Scale .99994450
 Convergence (dms) 0-57 15.335555

NAVD 1988

Elevation in meters 279.454
 Elevation in feet 916.842
 Geoid Ht. in meters -33.767
 Elevations determined with GPS

Azimuth: S 59° 08' 05" W to Station 203A.