

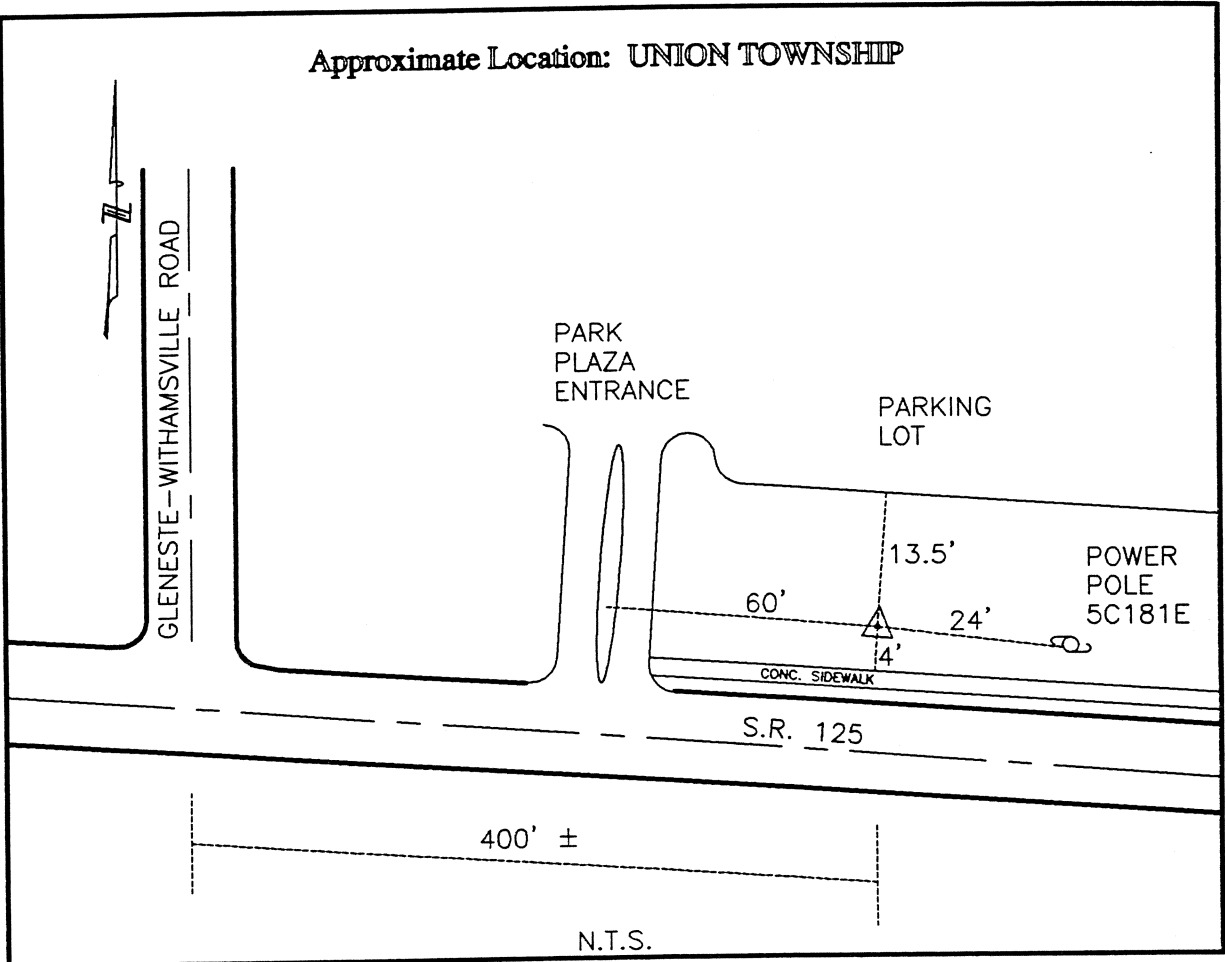

CLERMONT COUNTY ENGINEER
CONTROL STATION DATA SHEET

Approximate Location: UNION TOWNSHIP



Station Name: 213

NAD 1983 (First Order)

State Plane Zone: Ohio South 3402
 Latitude (dms) N 39 03 51.82114
 Longitude (dms) W 84 16 42.15687
 Easting in meters 446102.768
 Northing in meters 119677.400
 Easting in US survey ft 1463588.831
 Northing in US survey ft 392641.603
 Scale .99995140
 Convergence (dms) -1 7 42.293612

NAVD 1988

Elevation in meters 278.719
 Elevation in feet 914.431
 Geoid Ht. in meters -34.209
 Elevations determined with GPS

Azimuth: S 58° 08' 28" E to Station 213A.