

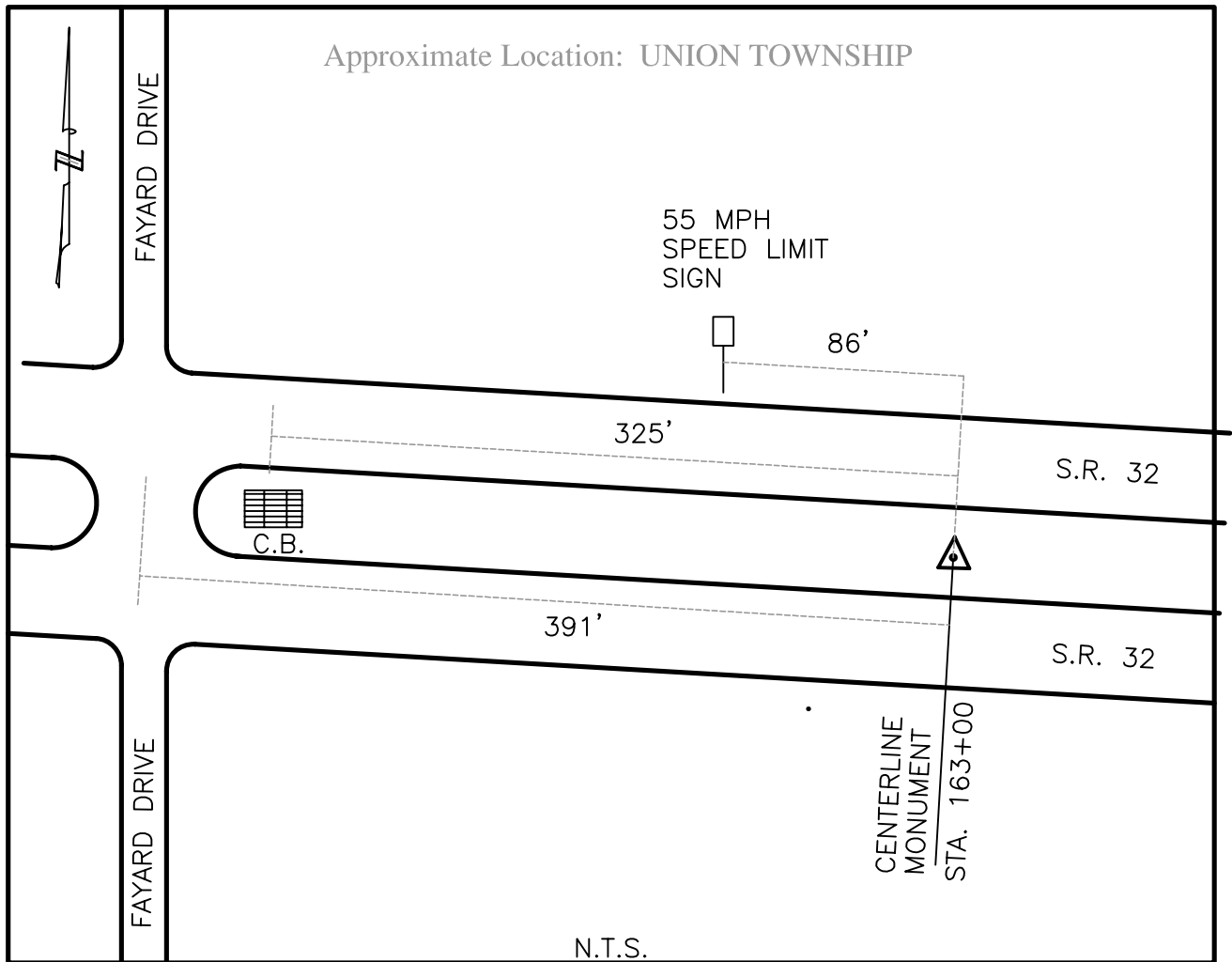

# CLERMONT COUNTY ENGINEER

## CONTROL STATION DATA SHEET



Station Name: 218

NAD 1983 (First Order)

State Plane Zone: Ohio South 3402  
 Latitude (dms) N 39 05 35.05144  
 Longitude (dms) W 84 15 24.18910  
 Easting in meters 448038.671  
 Northing in meters 122823.373  
 Easting in US survey ft 1469940.206  
 Northing in US survey ft 402963.016  
 Scale .99994870  
 Convergence (dms) -1 6 52.821538

NAVD 1988

Elevation in meters 267.220  
 Elevation in feet 876.704  
 Geoid Ht. in meters -34.186  
 Elevations determined with GPS

Azimuth: N 68° 41' 27" W to Station 218A