

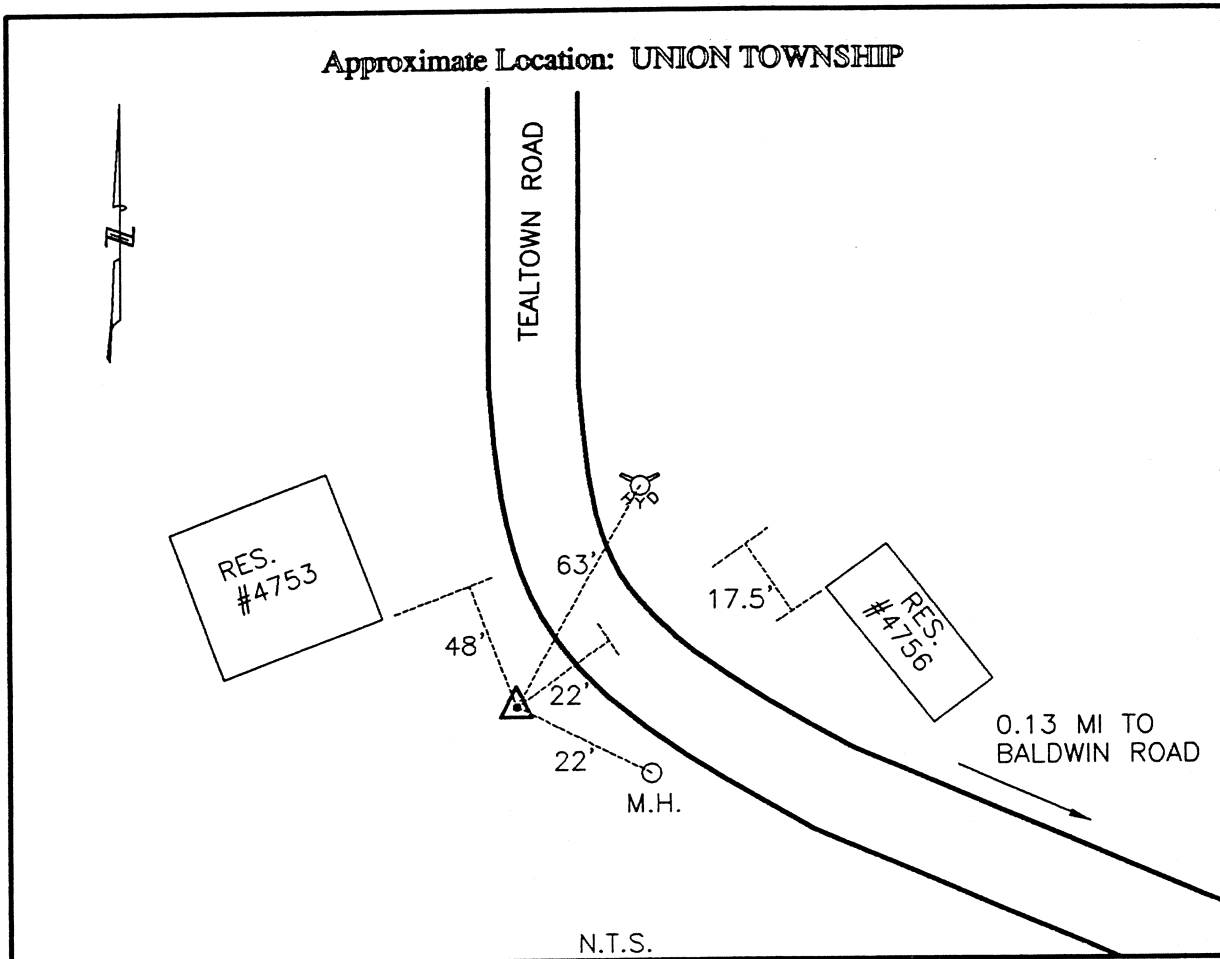

CLERMONT COUNTY ENGINEER
CONTROL STATION DATA SHEET

Approximate Location: UNION TOWNSHIP



Station Name: 223

NAD 1983 (First Order)

State Plane Zone: Ohio South 3402
 Latitude (dms) N 39 06 54.85655
 Longitude (dms) W 84 14 3.61593
 Easting in meters 450021.755
 Northing in meters 125246.410
 Easting in US survey ft 1476446.375
 Northing in US survey ft 410912.597
 Scale .99994690
 Convergence (dms) -1 6 1.696288

NAVD 1988

Elevation in meters 234.110
 Elevation in feet 768.076
 Geoid Ht. in meters -34.160
 Elevations determined with GPS

Azimuth: N 03° 36' 28" E to Station 223A.