

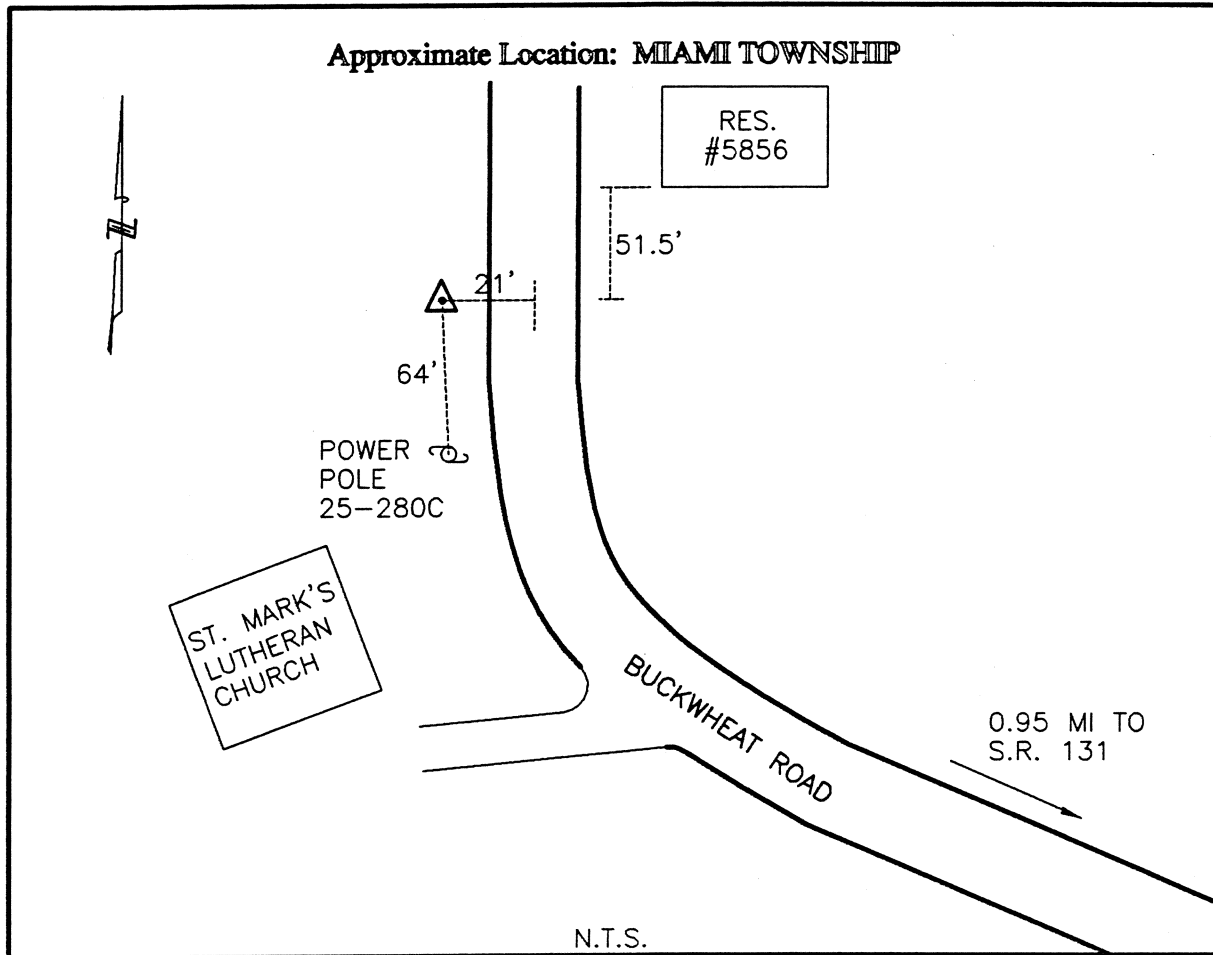

CLERMONT COUNTY ENGINEER  
CONTROL STATION DATA SHEET

Approximate Location: MIAMI TOWNSHIP



Station Name: 228

NAD 1983 (First Order)

State Plane Zone: Ohio South 3402  
 Latitude (dms) N 39 11 18.06862  
 Longitude (dms) W 84 13 5.00988  
 Easting in meters 451583.785  
 Northing in meters 133334.625  
 Easting in US survey ft 1481571.135  
 Northing in US survey ft 437448.682  
 Scale .99994170  
 Convergence (dms) -1 5 24.509604

NAVD 1988

Elevation in meters 268.369  
 Elevation in feet 880.474  
 Geoid Ht. in meters -34.068  
 Elevations determined with GPS

Azimuth: S 21° 00' 56" E to Station 228A.