

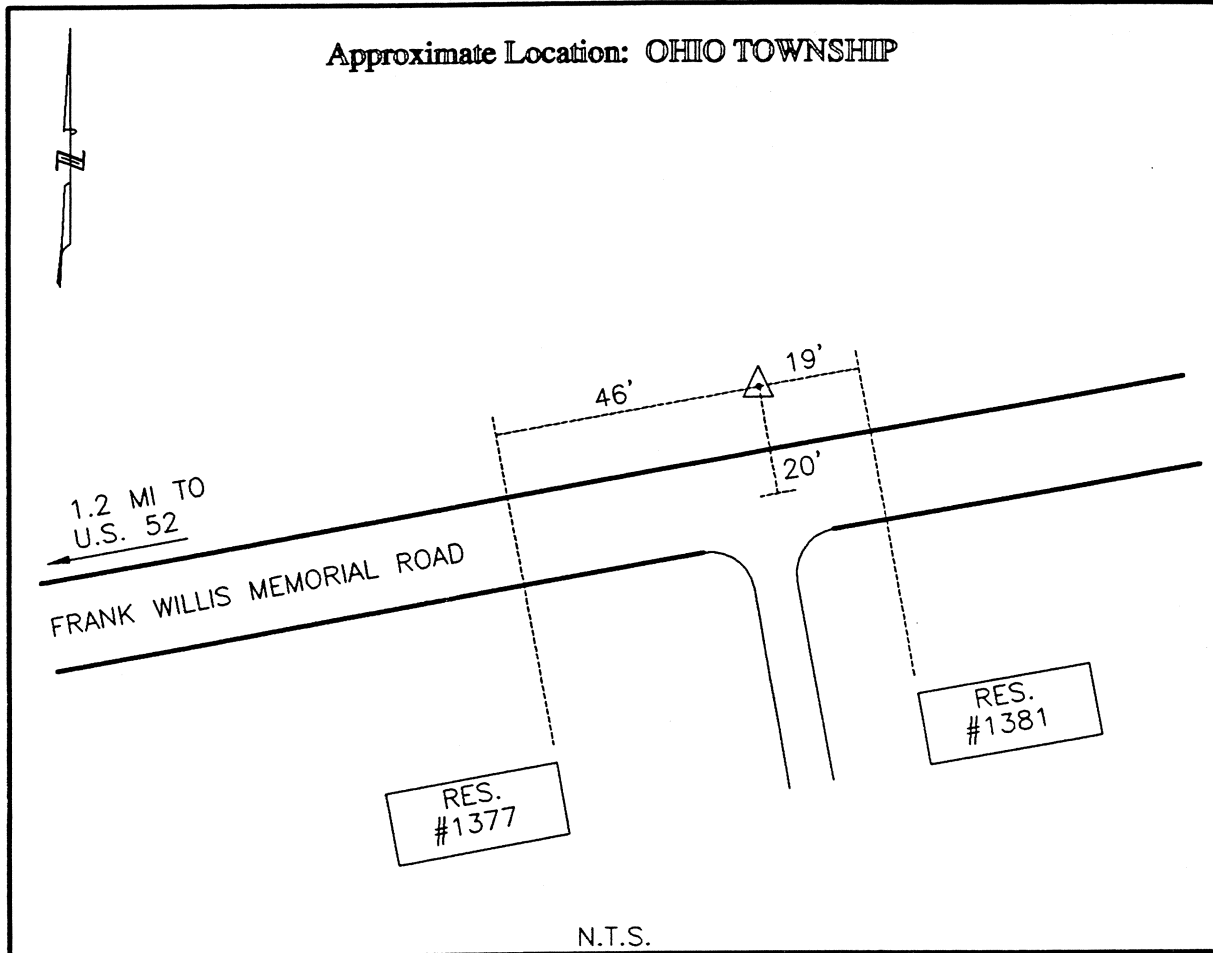

CLERMONT COUNTY ENGINEER
CONTROL STATION DATA SHEET

Approximate Location: OHIO TOWNSHIP



Station Name: 241

NAD 1983 (First Order)
State Plane Zone:
Latitude (dms)
Longitude (dms)
Easting in meters
Northing in meters
Easting in US survey ft
Northing in US survey ft
Scale
Convergence

Ohio South 3402
N 38 56 24.37033
W 84 14 47.71793
448586.477
105828.535
1471737.465
347205.785
0.99996578
-1 6 29.679867

NAVD 1988
Elevation in meters 251.126
Elevation in feet 823.903
Geoid Ht in meters -34.230
Elevations determined with GPS

Azimuth: S 54° 01' 58" E to Station 241A.