

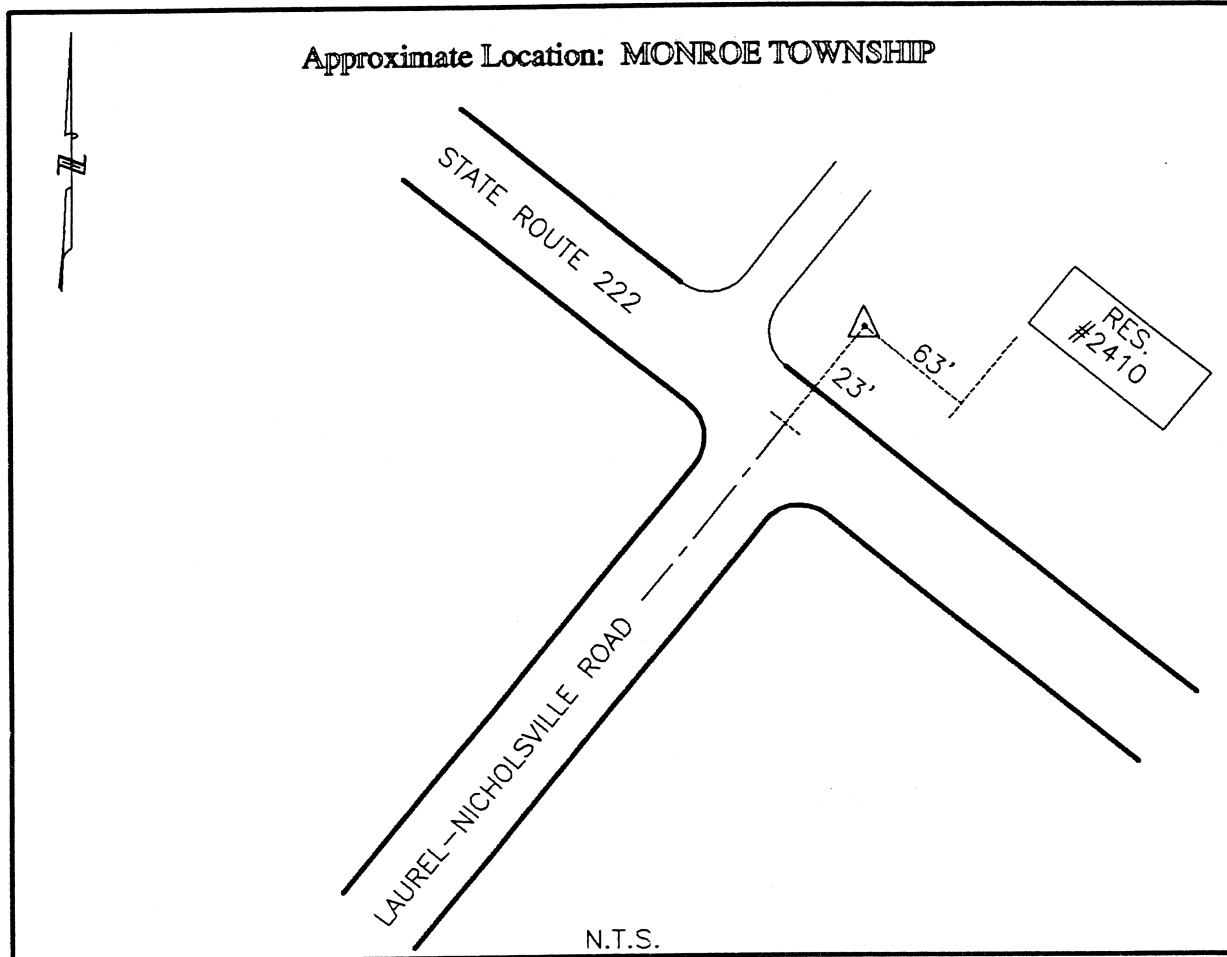

CLERMONT COUNTY ENGINEER
CONTROL STATION DATA SHEET

Approximate Location: MONROE TOWNSHIP



Station Name: 248

NAD 1983 (First Order)
State Plane Zone:
Latitude (dms)
Longitude (dms)
Easting in meters
Northing in meters
Easting in US survey ft
Northing in US survey ft
Scale
Convergence

Ohio South 3402
N 38 56 53.78658
W 84 09 53.78029
455680.645
106601.756
1495012.248
349742.594
0.99996469
-1 3 23.170696

NAVD 1988
Elevation in meters 276.409
Elevation in feet 906.852
Geoid Ht in meters -34.142
Elevations determined with GPS

Azimuth: S 35° 42' 34" E to Station 248A.