

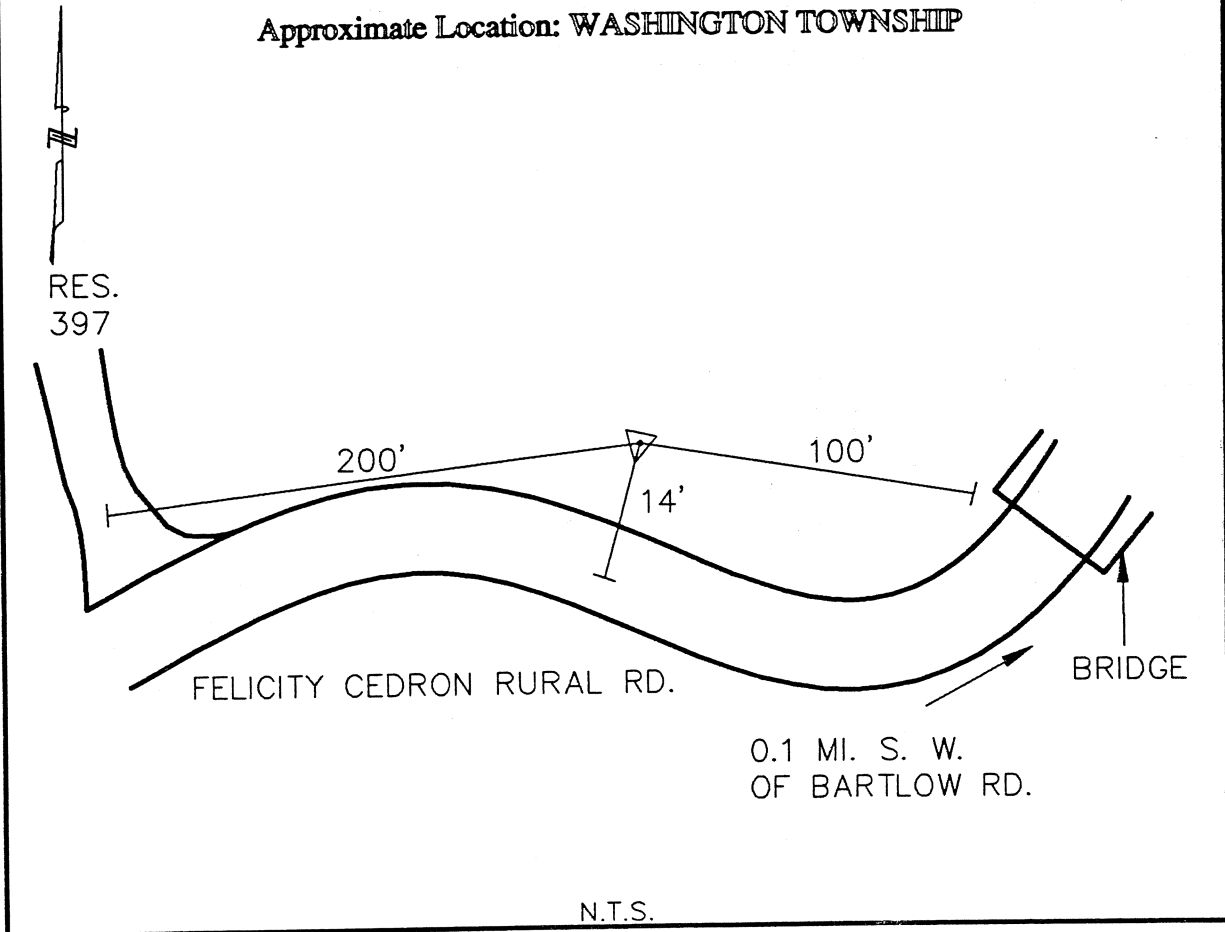

CLERMONT COUNTY ENGINEER  
CONTROL STATION DATA SHEET

Approximate Location: WASHINGTON TOWNSHIP



Station Name: 279

NAD 1983 (First Order)	Ohio South 3402
State Plane Zone:	N 38 48 2.24572
Latitude (dms)	W 84 03 33.28110
Longitude (dms)	464558.416
Easting in meters	90049.927
Northing in meters	1524138.735
Easting in US survey ft	295438.802
Northing in US survey ft	0.99998745
Scale	0-59 21.736526
Convergence	

NAVD 1988	
Elevation in meters	160.066
Elevation in feet	525.150
Geoid Ht in meters	-34.081
Elevations determined with GPS	

Azimuth: S 83° 33' 13" W to Station 279A.