

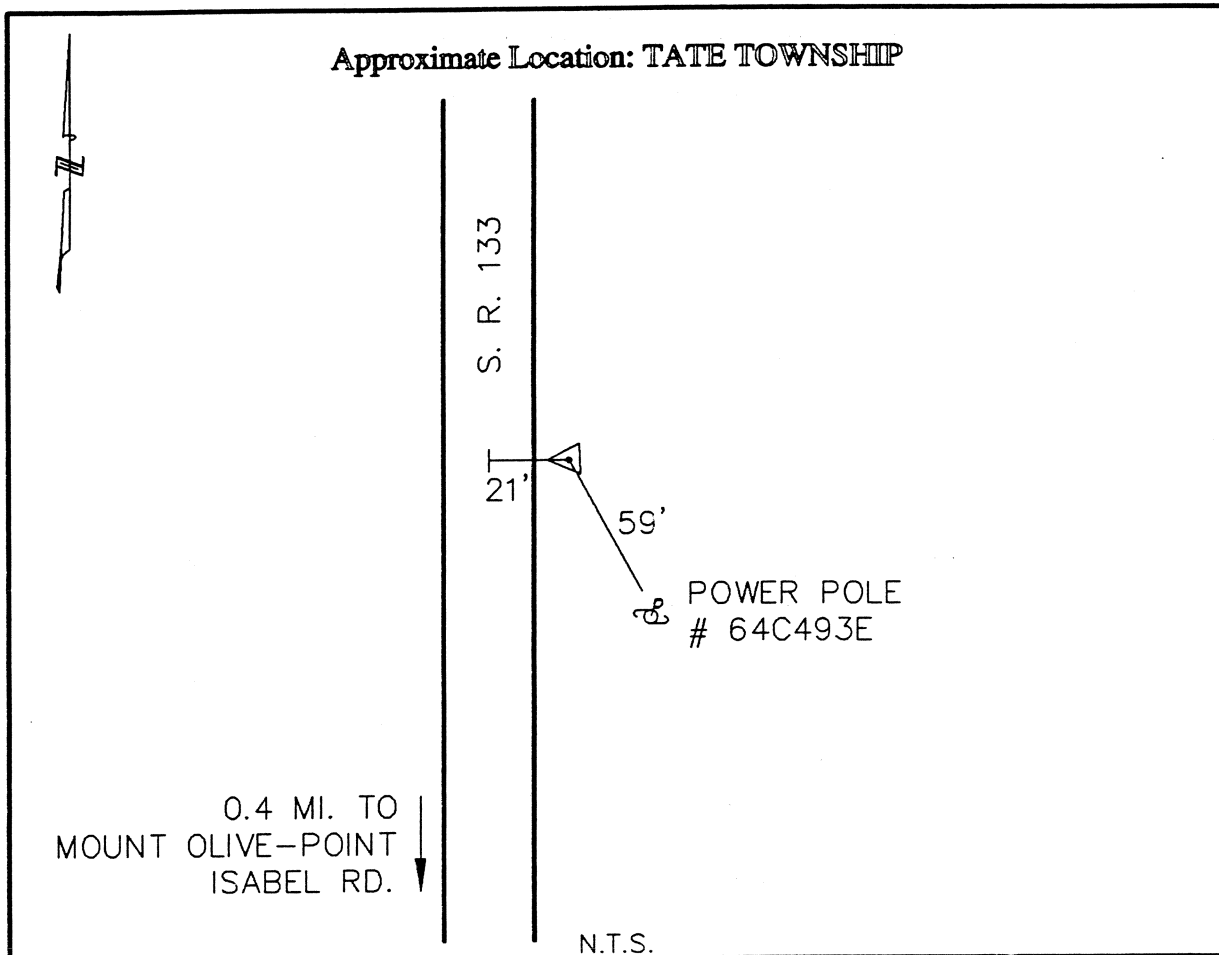

CLERMONT COUNTY ENGINEER

CONTROL STATION DATA SHEET

Approximate Location: TATE TOWNSHIP



Station Name: 305

NAD 1983 (First Order)
 State Plane Zone: Ohio South 3402
 Latitude (dms) N 38 53 56.92051
 Longitude (dms) W 84 05 24.42692
 Easting in meters 462069.463
 Northing in meters 101031.821
 Easting in US survey ft 1515972.895
 Northing in US survey ft 331468.566
 Scale 0.99997154
 Convergence -1 0 32.260715

NAVD 1988
 Elevation in meters 272.547
 Elevation in feet 894.181
 Geoid Ht in meters -34.071
 Elevations determined with GPS

Azimuth: N 07° 25' 05" E to Station 305A.