

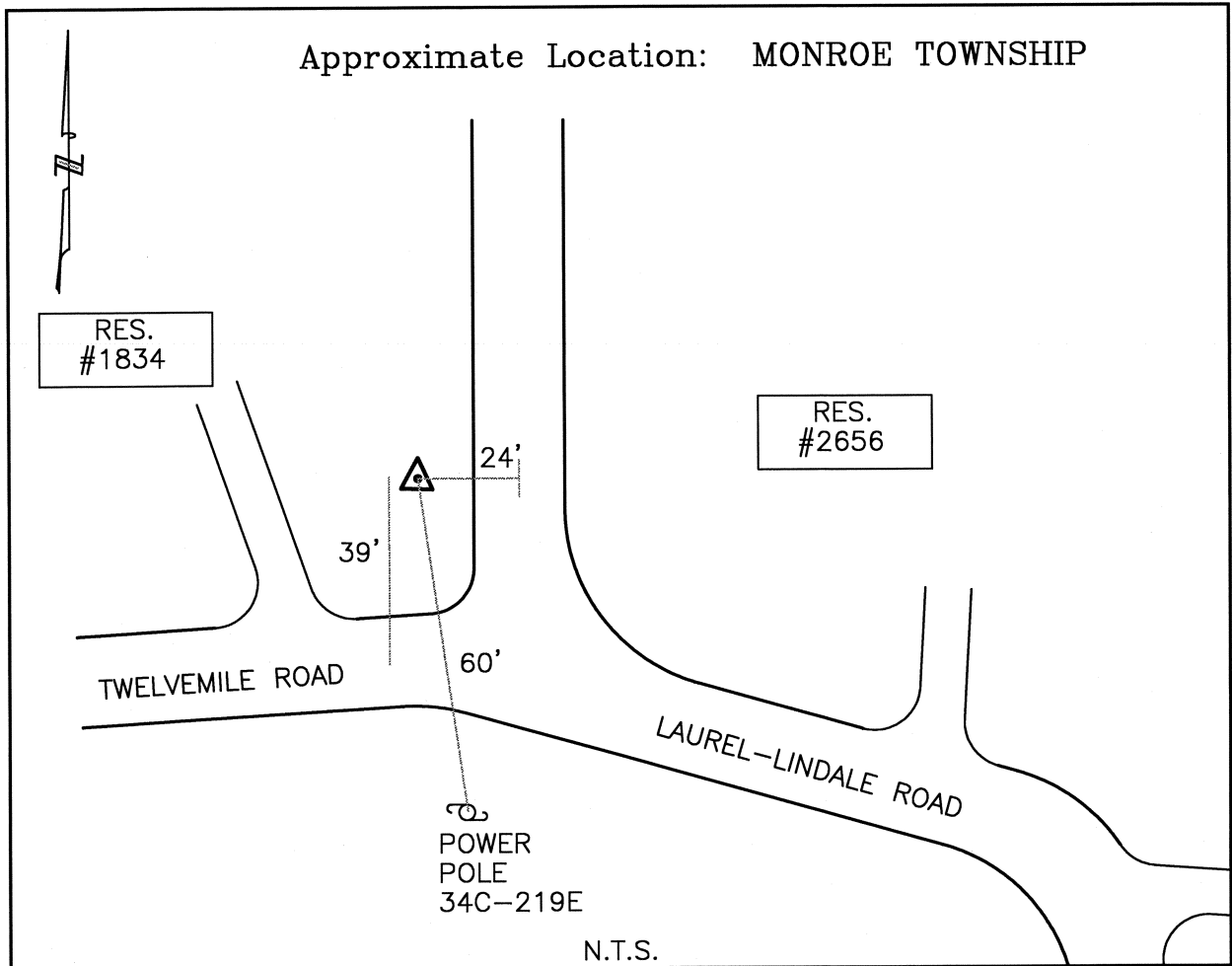

CLERMONT COUNTY ENGINEER

CONTROL STATION DATA SHEET



Station Name: 37

NAD 1983 (First Order)		NAVD 1988	
State Plane Zone:	Ohio South 3402	Elevation in meters	216.841
Latitude (dms)	N 38 58 6.07053	Elevation in feet	711.419
Longitude (dms)	W 84 12 9.79231	Geoid Ht in meters	-34.176
Easting in meters	452448.134	Elevations determined with GPS	
Northing in meters	108891.397		
Easting in US survey ft	1484406.918		
Northing in US survey ft	357254.525		
Scale	0.99996211		
Convergence	-1 4 49.472975		

Azimuth: S 78° 09' 34" E to Station 37A.