

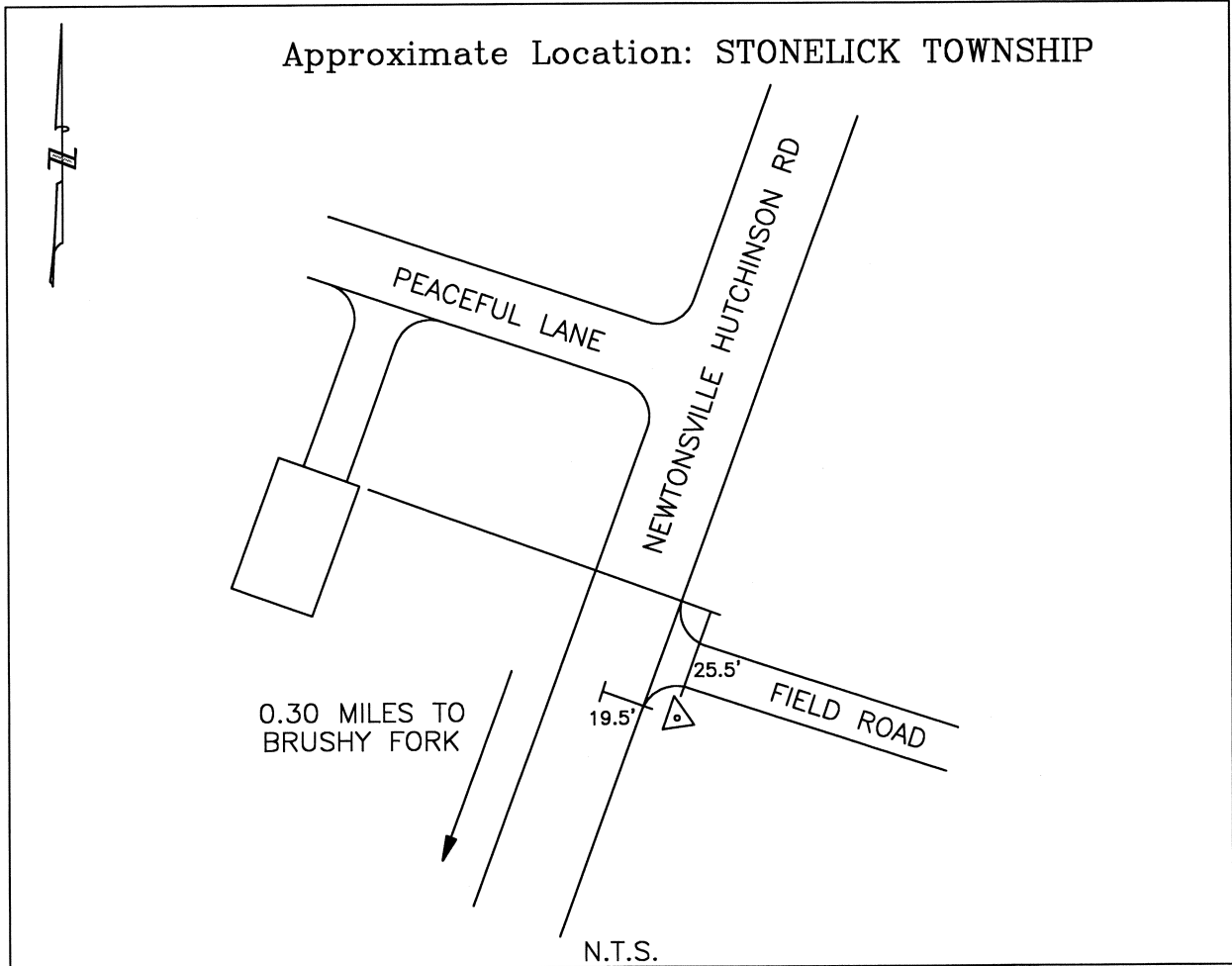

CLERMONT COUNTY ENGINEER CONTROL STATION DATA SHEET

Approximate Location: STONELICK TOWNSHIP



Station Name: 385

NAD 1983
 State Plane Zone: Ohio South 3402
 Latitude (dms) N 39 09 5.96720
 Longitude (dms) W 84 05 37.07913
 Easting in meters 462259.334
 Northing in meters 129064.574
 Easting in US survey ft 1516595.832
 Northing in US survey ft 423439.356
 Scale 0.99994411
 Convergence -1 0 40.288790

NAVD 1988
 Elevation in meters 273.217
 Elevation in feet 896.379
 Geoid96 Ht in meters -33.719
 Elevations determined with GPS

Azimuth: S.22°41'49"W. to Station 385A