

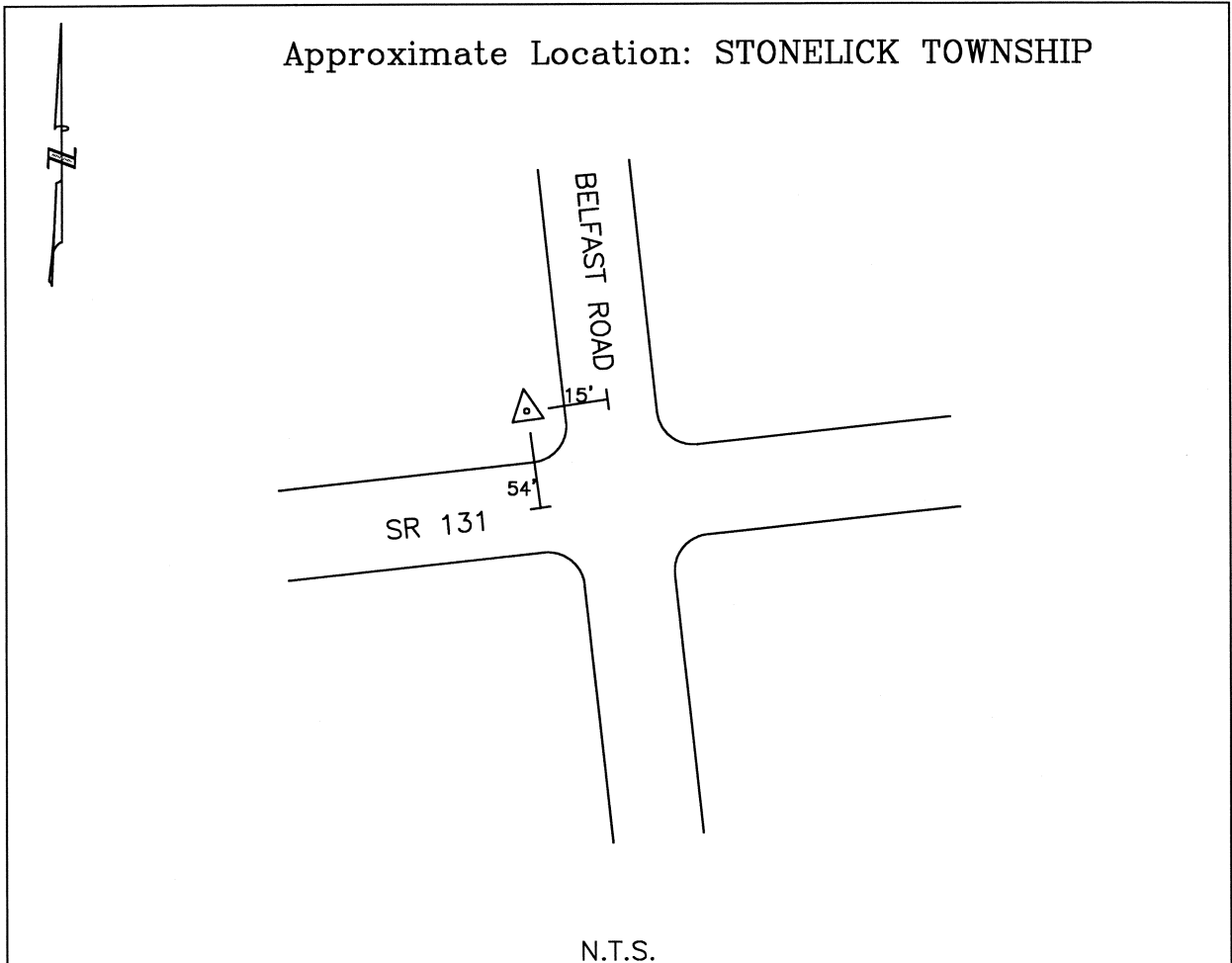

CLERMONT COUNTY ENGINEER

CONTROL STATION DATA SHEET

Approximate Location: STONELICK TOWNSHIP



Station Name: 392

NAD 1983

State Plane Zone: Ohio South 3402

Latitude (dms) N 39 10 27.94275

Longitude (dms) W 84 08 28.44189

Easting in meters 458191.501

Northing in meters 131665.710

Easting in US survey ft 1503249.950

Northing in US survey ft 431973.251

Scale 0.99994259

Convergence -1 2 29.021813

NAVD 1988

Elevation in meters 271.591

Elevation in feet 891.045

Geoid99 Ht in meters -33.774

Elevations determined with GPS

Azimuth: N.10°36'03"W. to Station 392A