

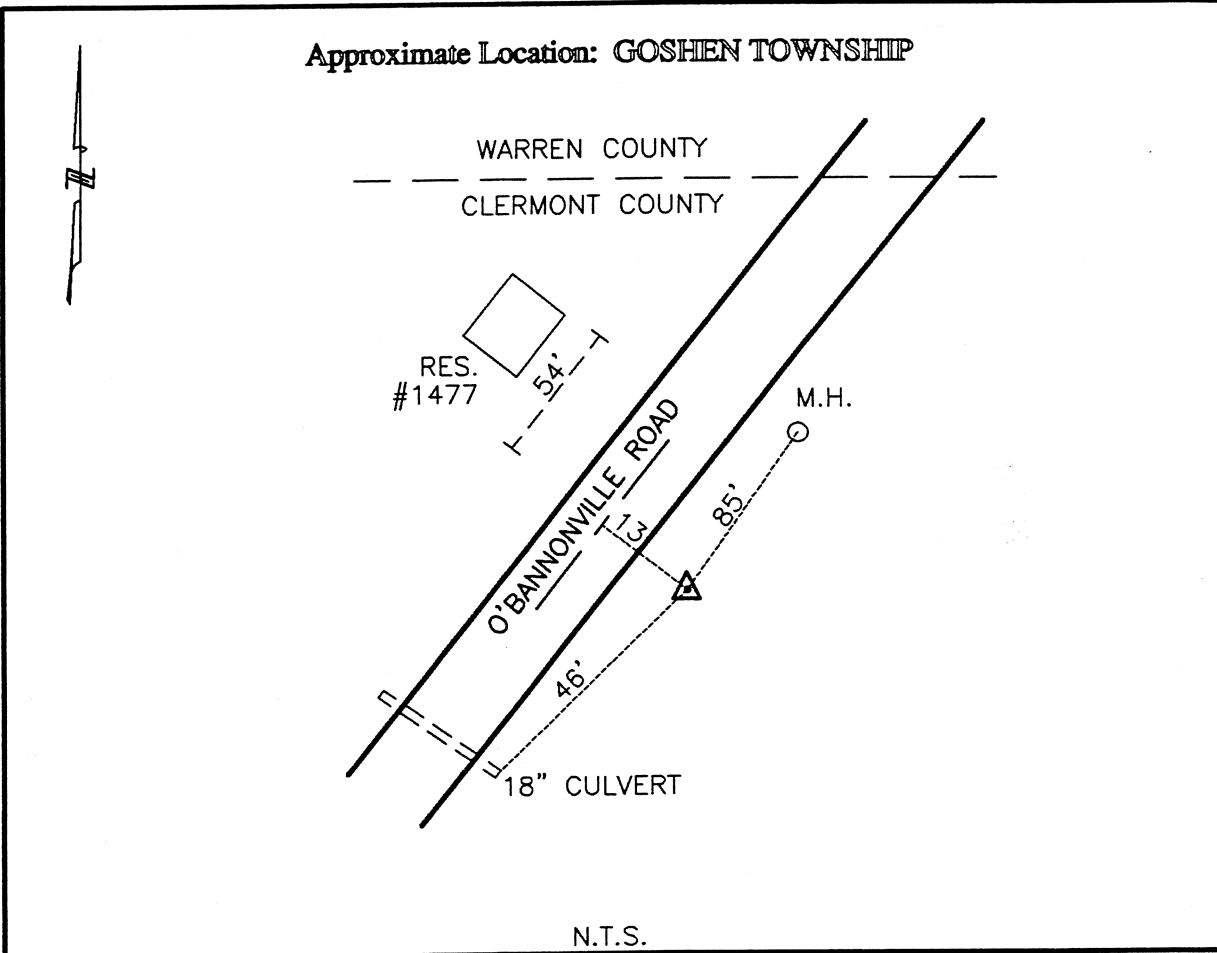

CLERMONT COUNTY ENGINEER CONTROL STATION DATA SHEET

Approximate Location: GOSHEN TOWNSHIP



Station Name: 72

NAD 1983 (First Order)

State Plane Zone: Ohio South 3402
 Latitude (dms) N 39 16 1.20785
 Longitude (dms) W 84 12 7.93655
 Easting in meters 453117.741
 Northing in meters 142038.296
 Easting in US survey ft 1486603.789
 Northing in US survey ft 466003.976
 Scale .99993800
 Convergence (dms) -1 4 48.295461

NAVD 1988

Elevation in meters 238.258
 Elevation in feet 781.685
 Geoid Ht. in meters -33.953
 Elevations determined with GPS

Azimuth: S 73° 17' 13" W to Station 72A