

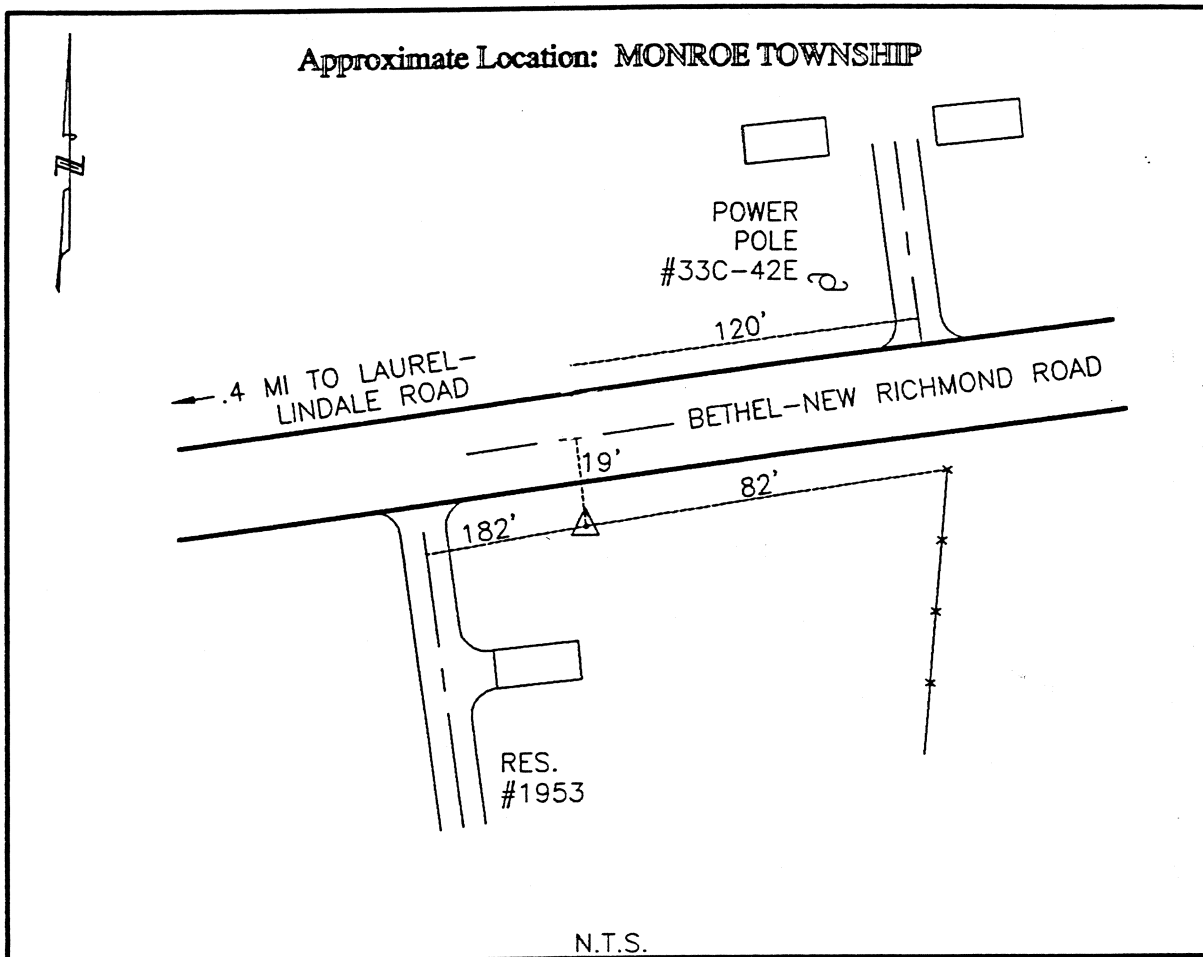

CLERMONT COUNTY ENGINEER

CONTROL STATION DATA SHEET

Approximate Location: MONROE TOWNSHIP



Station Name: 82

NAD 1983 (First Order)

State Plane Zone: Ohio South 3402
 Latitude (dms) N 38 57 23.09795
 Longitude (dms) W 84 11 38.52149
 Easting in meters 453175.916
 Northing in meters 107552.358
 Easting in US survey ft 1486794.651
 Northing in US survey ft 352861.361
 Scale .99996360
 Convergence (dms) -1 4 29.631031

NAVD 1988

Elevation in meters 264.512
 Elevation in feet 867.820
 Geoid Ht. in meters -34.171
 Elevations determined with GPS

Azimuth: S 81° 08' 47" W to Station 82A.