

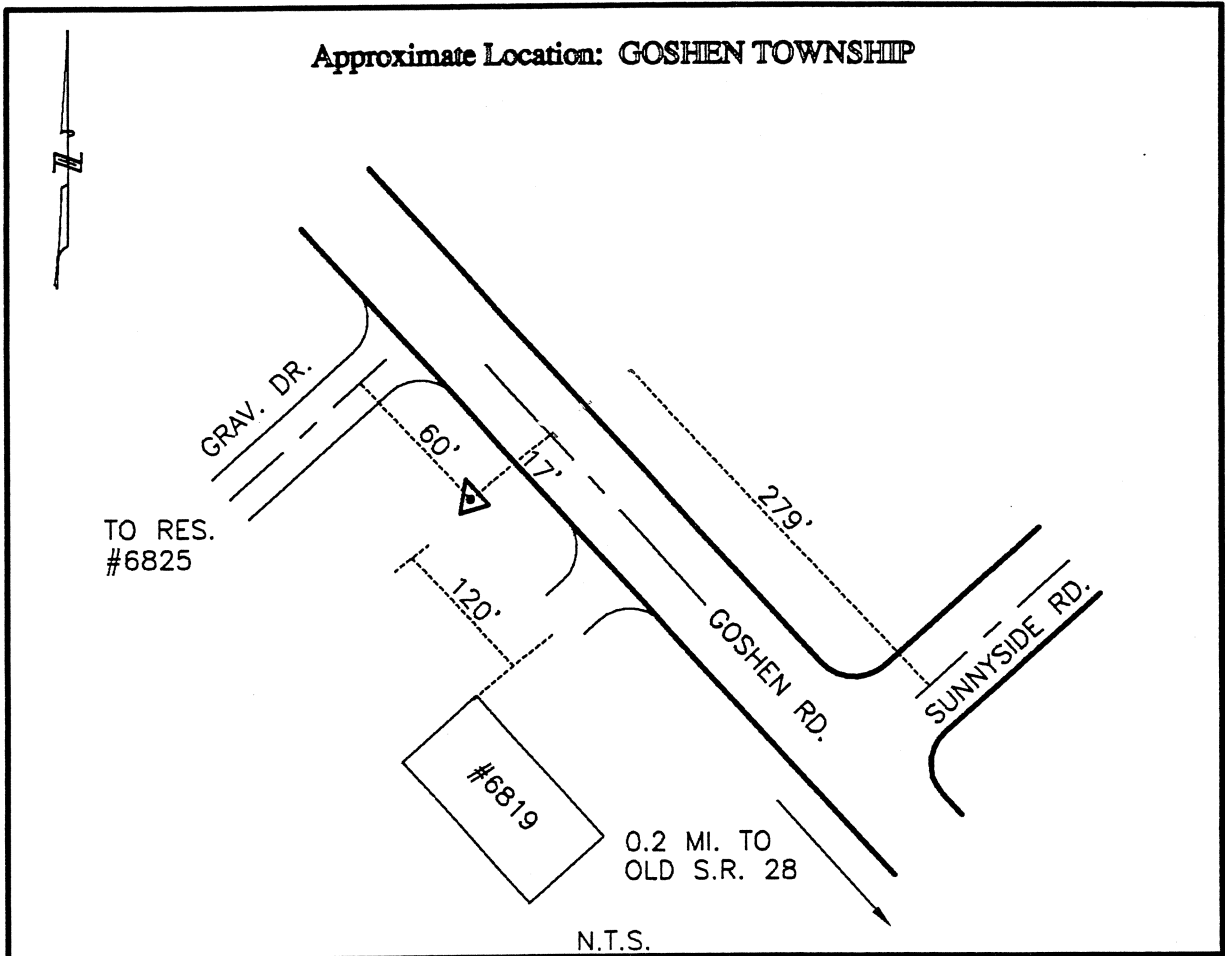

CLERMONT COUNTY ENGINEER  
CONTROL STATION DATA SHEET



Station Name: 96

NAD 1983 (First Order)

State Plane Zone: Ohio South 3402  
 Latitude (dms) N 39 14 9.65596  
 Longitude (dms) W 84 09 53.41651  
 Easting in meters 456278.302  
 Northing in meters 138538.831  
 Easting in US survey ft 1496973.062  
 Northing in US survey ft 454522.815  
 Scale .99993930  
 Convergence (dms) -1 3 22.939868

NAVD 1988

Elevation in meters 254.369  
 Elevation in feet 834.542  
 Geoid Ht. in meters -33.947  
 Elevations determined with GPS

Azimuth: S 39° 33' 02" E to Station 96A.