

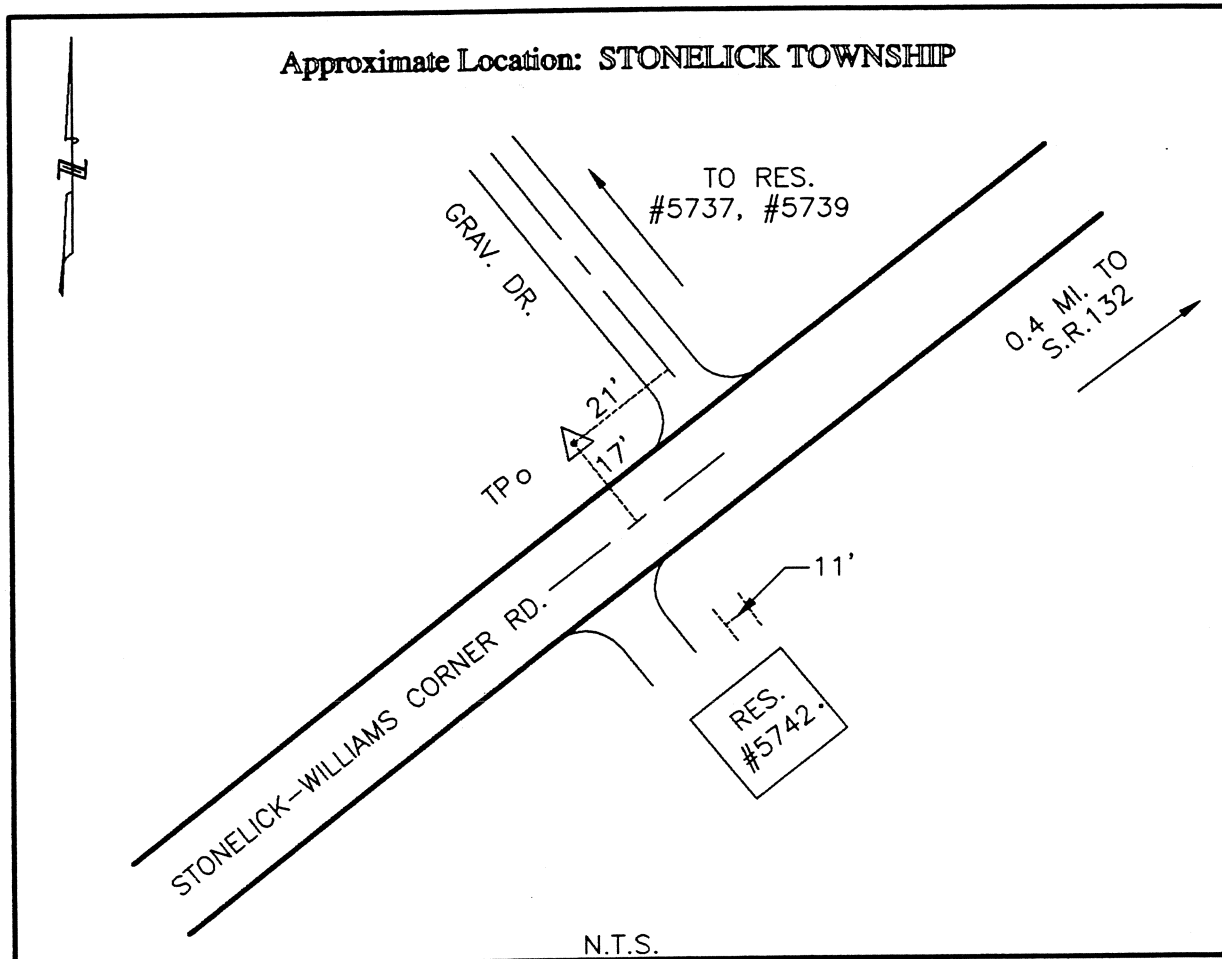

CLERMONT COUNTY ENGINEER
CONTROL STATION DATA SHEET



Station Name: 99

NAD 1983 (First Order)

State Plane Zone: Ohio South 3402
 Latitude (dms) N 39 09 55.30639
 Longitude (dms) W 84 09 46.47985
 Easting in meters 456300.190
 Northing in meters 130693.749
 Easting in US survey ft 1497044.873
 Northing in US survey ft 428784.408
 Scale .99994320
 Convergence (dms) -1 3 18.538421

NAVD 1988

Elevation in meters 261.911
 Elevation in feet 859.286
 Geoid Ht. in meters -34.029
 Elevations determined with GPS

Azimuth: S 46° 06' 06" W to Station 99A.