

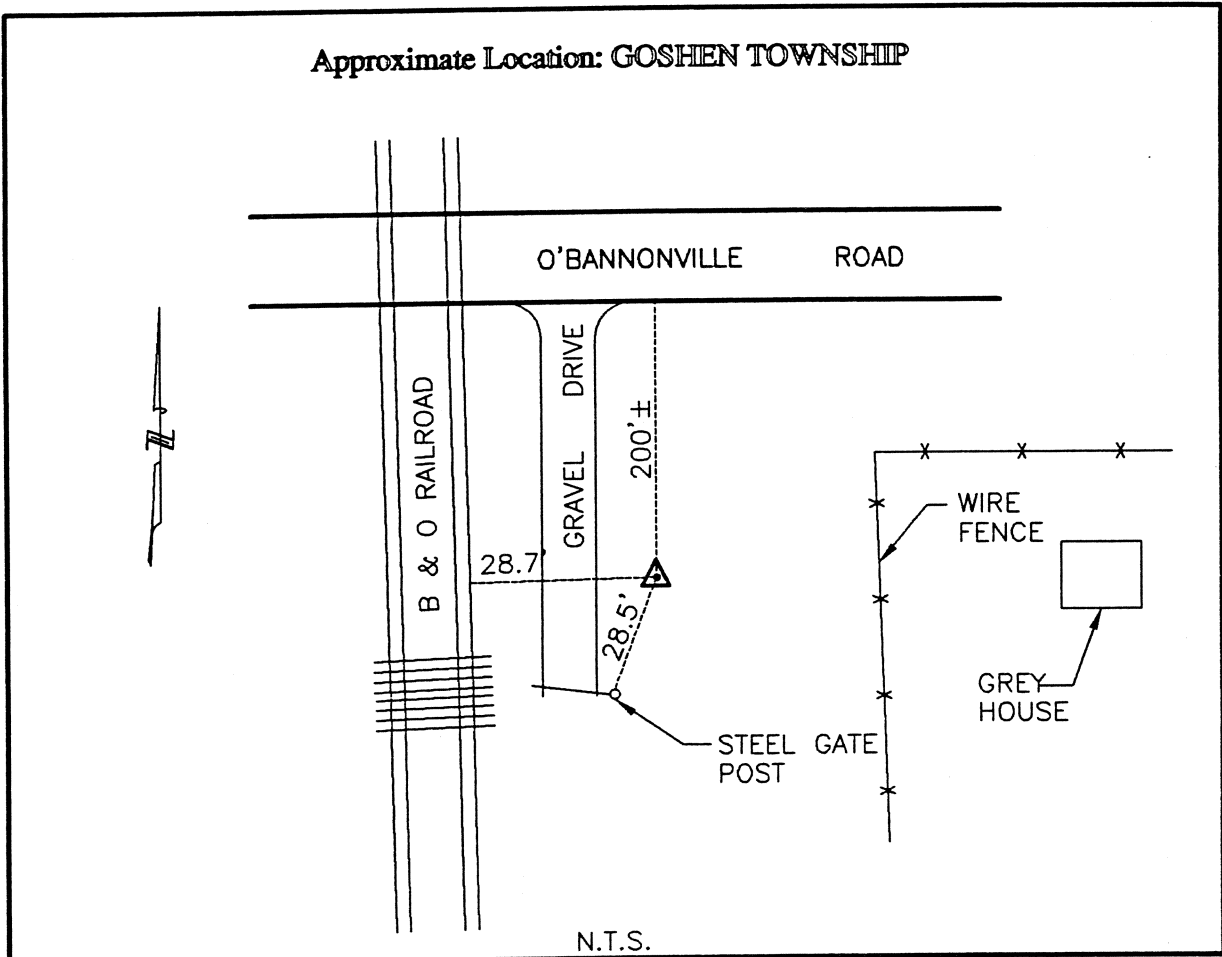

# CLERMONT COUNTY ENGINEER CONTROL STATION DATA SHEET

Approximate Location: GOSHEN TOWNSHIP



Station Name: G023

NAD 1983 (First Order)

State Plane Zone: Ohio South 3402  
 Latitude (dms) N 39 15 52.71721  
 Longitude (dms) W 84 13 51.01106  
 Easting in meters 450642.401  
 Northing in meters 141823.482  
 Easting in US survey ft 1478482.611  
 Northing in US survey ft 465299.207  
 Scale .99993810  
 Convergence (dms) -1 5 53.698252

NAVD 1988

Elevation in meters 192.616  
 Elevation in feet 631.941  
 Geoid Ht. in meters -33.988  
 Elevations determined with GPS

Azimuth: N 29° 15' 22" W to Station G023A.