

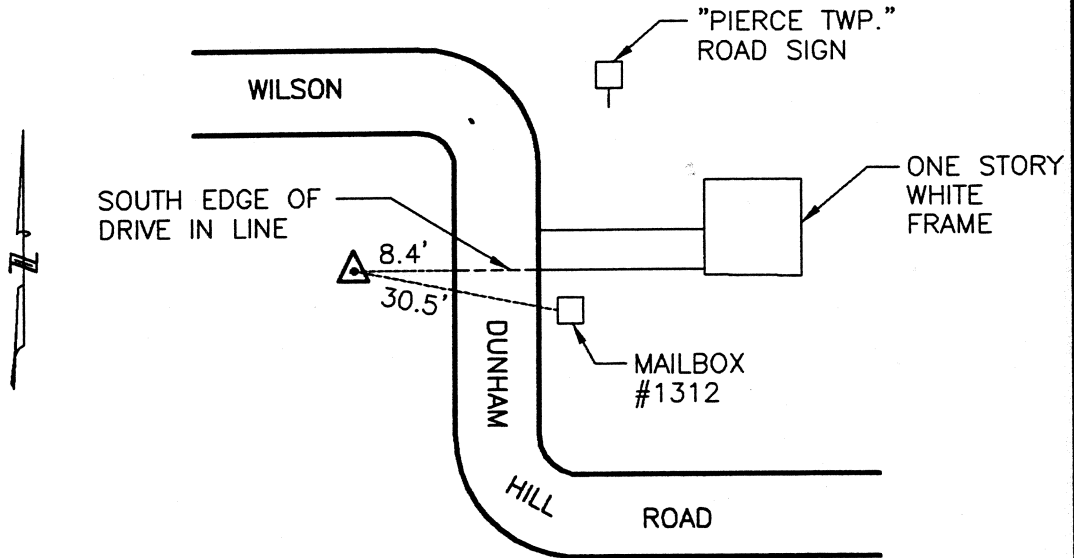

CLERMONT COUNTY ENGINEER  
CONTROL STATION DATA SHEET

Approximate Location: OHIO TOWNSHIP



N.T.S.

Station Name: OH03

NAD 1983 (First Order)

State Plane Zone: Ohio South 3402  
 Latitude (dms) N 38 59 21.20460  
 Longitude (dms) W 84 14 48.14196  
 Easting in meters 448681.741  
 Northing in meters 111280.625  
 Easting in US survey ft 1472050.012  
 Northing in US survey ft 365093.184  
 Scale .99995950  
 Convergence (dms) -1 6 29.948924

NAVD 1988

Elevation in meters 237.916  
 Elevation in feet 780.563  
 Geoid Ht. in meters -34.214  
 Elevations determined with GPS

Azimuth: N 76° 50' 05" W to Station 3A.