

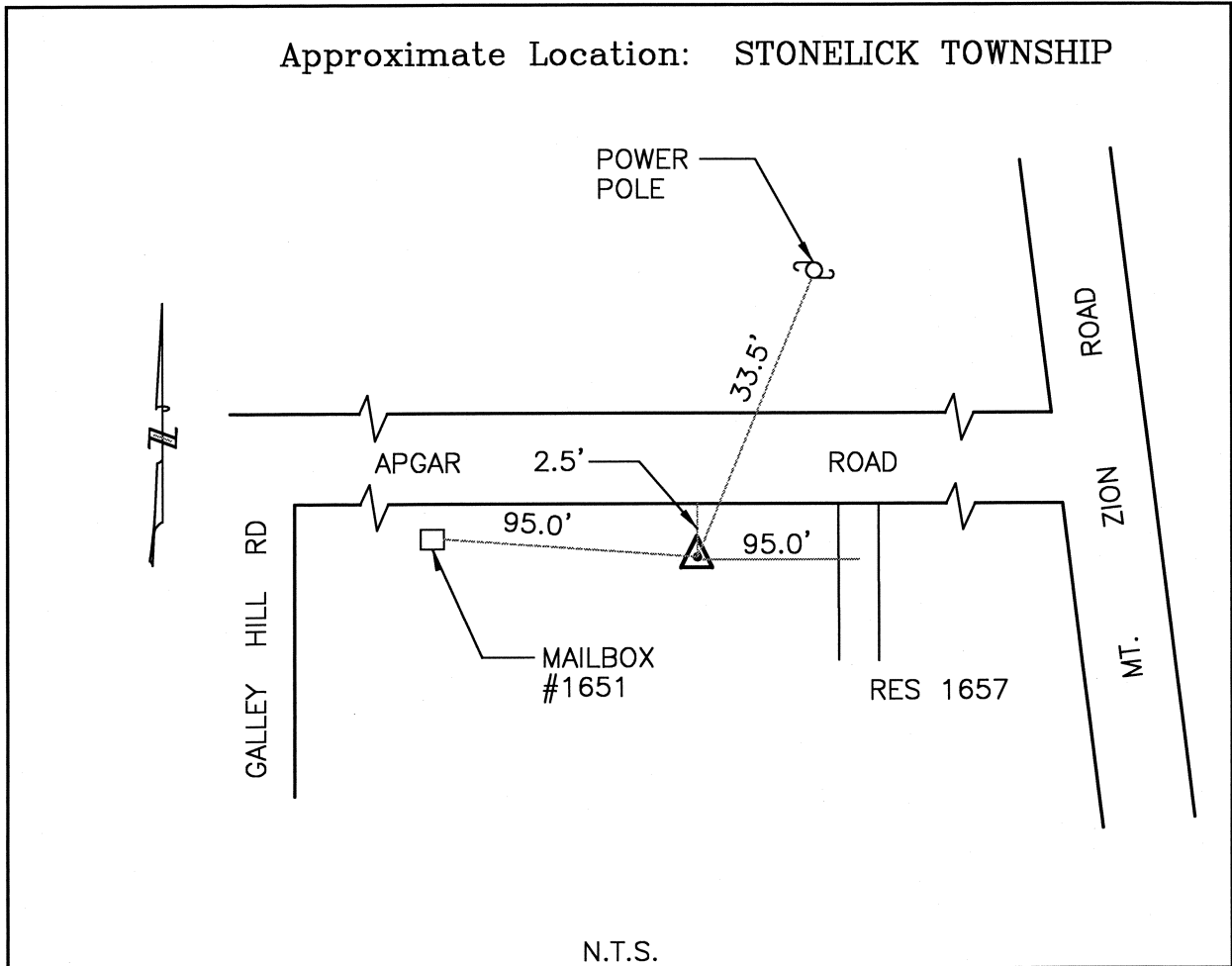

CLERMONT COUNTY ENGINEER CONTROL STATION DATA SHEET

Approximate Location: STONELICK TOWNSHIP



Station Name: ST14

NAD 1983 (First Order)

State Plane Zone: Ohio South 3402
 Latitude (dms) N 39 09 24.43381
 Longitude (dms) W 84 11 46.64593
 Easting in meters 453398.170
 Northing in meters 129795.560
 Easting in US survey ft 1487523.829
 Northing in US survey ft 425837.600
 Scale .99994370
 Convergence (dms) -1 4 34.786147

NAVD 1988

Elevation in meters 261.631
 Elevation in feet 858.368
 Geoid Ht. in meters -34.083
 Elevations determined with GPS

Azimuth: N 82° 55' 06" W to Station M114A.