

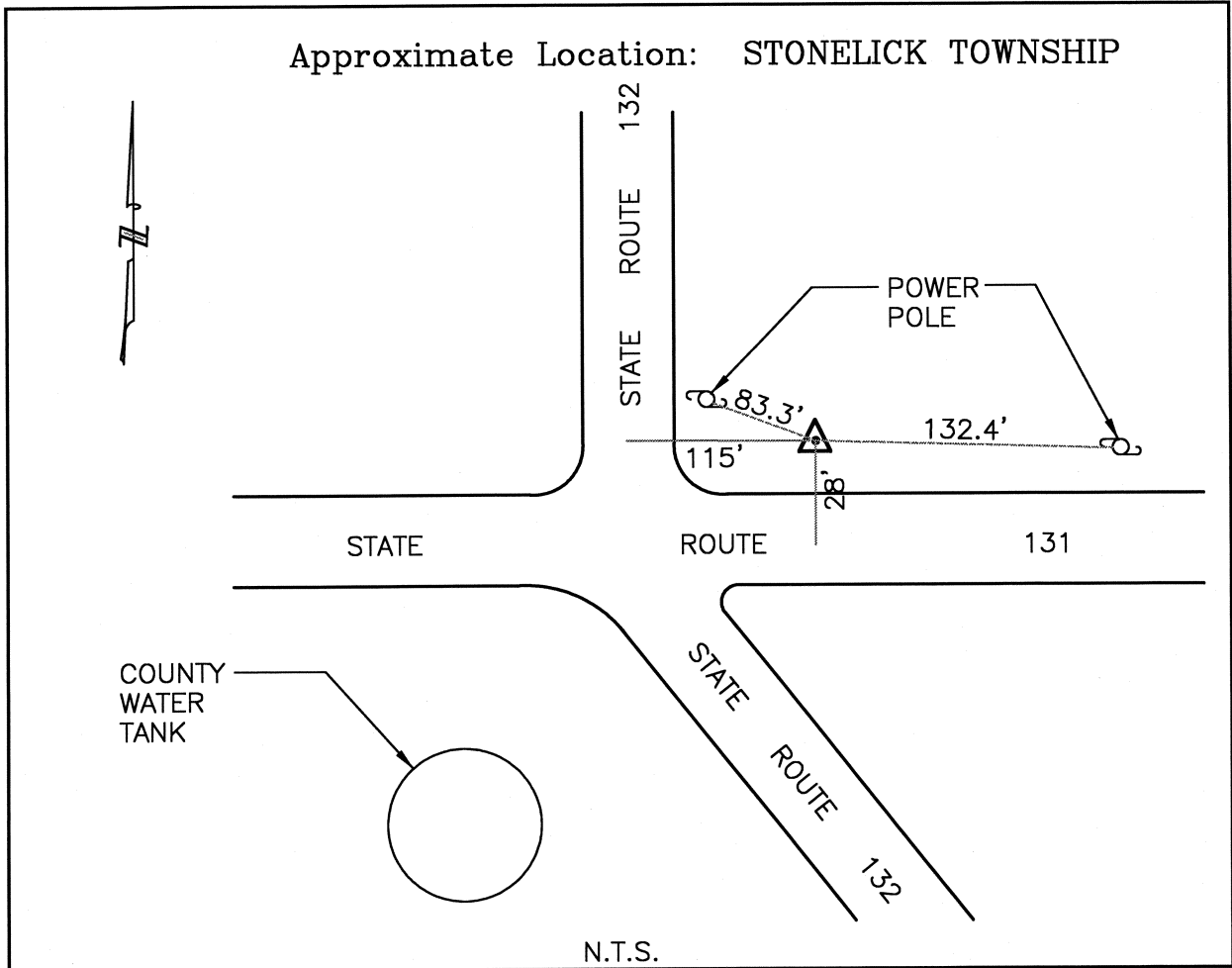

CLERMONT COUNTY ENGINEER CONTROL STATION DATA SHEET

Approximate Location: STONELICK TOWNSHIP



Station Name: ST16

NAD 1983 (First Order)

State Plane Zone: Ohio South 3402
 Latitude (dms) N 39 10 21.52777
 Longitude (dms) W 84 09 37.38125
 Easting in meters 456533.436
 Northing in meters 131498.176
 Easting in US survey ft 1497810.115
 Northing in US survey ft 431423.599
 Scale .99994270
 Convergence (dms) -1 3 12.765182

NAVD 1988

Elevation in meters 267.418
 Elevation in feet 877.354
 Geoid Ht. in meters -34.017
 Elevations determined with GPS

Azimuth: S 86° 03' 27" E to Station ST16A.