

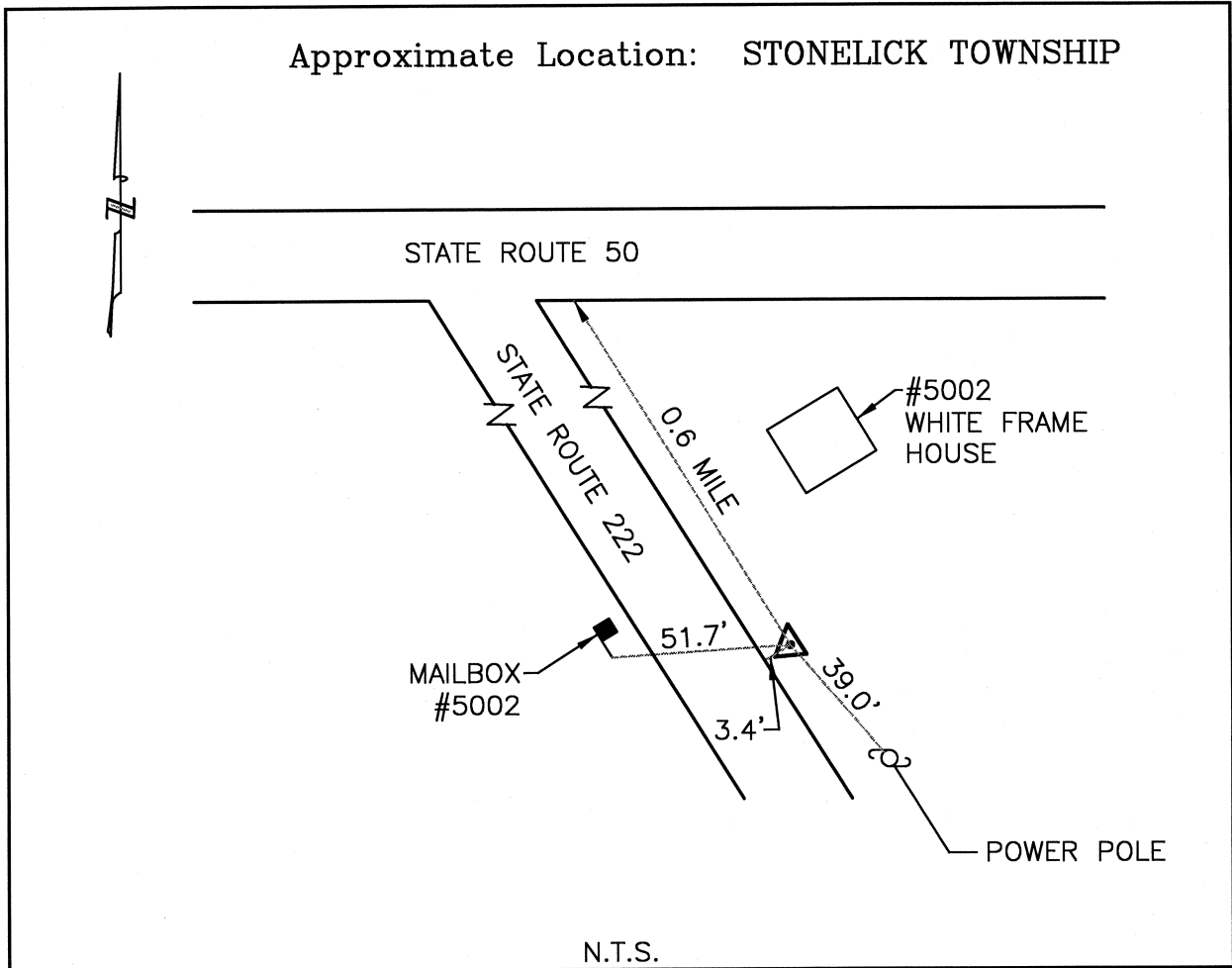

CLERMONT COUNTY ENGINEER CONTROL STATION DATA SHEET

Approximate Location: STONELICK TOWNSHIP



Station Name: ST43

NAD 1983 (First Order)

State Plane Zone: Ohio South 3402
 Latitude (dms) N 39 06 55.14571
 Longitude (dms) W 84 11 43.80023
 Easting in meters 453380.044
 Northing in meters 125191.541
 Easting in US survey ft 1487464.361
 Northing in US survey ft 410732.581
 Scale .99994690
 Convergence (dms) -1 4 32.980495

NAVD 1988

Elevation in meters 169.947
 Elevation in feet 557.568
 Geoid Ht. in meters -34.123
 Elevations determined with GPS

Azimuth: N 13° 05' 14" W to Station ST43A.